



# A Breathtaking Skyscraper at the Heart of a Vibrant New City Centre Community

Breathtaking design. An icon on the skyline. The finest residential homes in the city.

The Blade, Manchester will become one of the city's most distinctive landmarks. A magnificent architectural achievement.

Inside are living spaces that raise the benchmark for quality in Manchester, along with the finest communal facilities.

Located at the heart of Manchester's new skyscraper district. The Blade, Manchester is your next opportunity to invest in the most in-demand new neighbourhood in the city.



## OVERVIEW

### COMPLETION DATE:

Q4 2023

### DEVELOPER:

Renaker Build Limited

### EXCLUSIVE SALES PARTNER:

Select Property Group

### LOCATION:

Manchester M15 4AX

### PROJECTED YIELD:

6% yield

### ESTIMATED SERVICE CHARGE:

GBP 2.75 per sq.ft.

## Quintessential City Centre Living

- 52 storeys, with spectacular views across the Manchester skyline
- 414 premium one, two and three-bedroom residential apartments, lux apartments and penthouses
- Contemporary, state-of-the-art gymnasium with separate studio for fitness classes
- Residents-only sauna/steam room
- Premium live/work lounge & private dining room
- Rooftop terrace located on the podium level, designed to capture afternoon sunshine
- Residents lounge, opening out onto the terrace
- Picturesque community park on the ground level of the building
- Podium-level retail space
- Primary school located adjacent to the tower

# The Gateway to the City

THE BLADE, MANCHESTER IS IDEALLY SITUATED AT THE ENTRANCE OF THE CITY CENTRE.



## Typical Floorplan

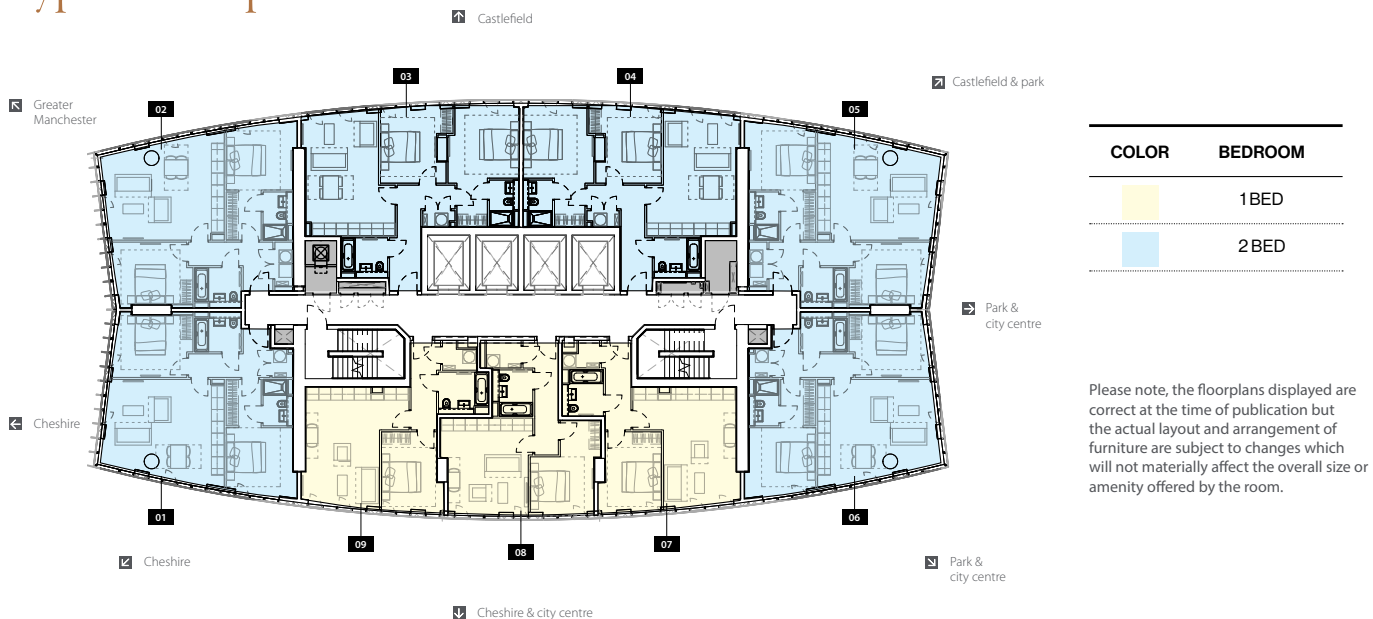

## Pricing

PROPERTY TYPE	STARTING PRICE
131x One-Bedroom Apartments	GBP 247,000 up to GBP 327,650
263x Two-Bedroom Apartments	GBP 310,000 up to GBP 472,818
15x Three-Bedroom Apartments	GBP 496,511 up to GBP 539,101
5x Penthouse Apartments	GBP 1,282,912 up to GBP 1,721,049

For further information

UK: +44 (0) 207 123 4000  
 UAE: +971 4 279 4800  
 Shanghai: +86 21 5243 520  
 Hong Kong: +852 3157 0896  
 Email: [info@selectproperty.com](mailto:info@selectproperty.com)





RESIDENTS LOUNGE AND CO-WORKING SPACE



TERRACE LOUNGE AND PODIUM ENTRANCE



TERRACE LOUNGE



PRIVATE DINING



STATE-OF-THE-ART GYMNASIUM



PODIUM TERRACE

