



NEW GARDEN QUARTER

S T R A T F O R D E 1 5

FLOORPLANS



NEW GARDEN QUARTER

STRATFORD E15

*A contemporary interpretation
of the classic London Square.*

*Creating a beautiful living space on the fringe
of London's largest urban park.*

A brand new collection of 1, 2 & 3 bedroom apartments, villas and sky villas set around a beautifully landscaped 2 acre garden square, next to the Queen Elizabeth Olympic Park and the thriving commercial and retail heart of Westfield in fashionable Stratford.

A new community of stylish apartments, villas and sky villas set in trendy Stratford, the hub of 21st century East London

New Garden Quarter is a striking, contemporary development of chic apartments and roomy villas located next to Stratford's world-renowned Queen Elizabeth Olympic Park, the destination Westfield shopping centre and the enviably connected Stratford Station. Set in landscaped grounds, these 1, 2 and 3 bedroom apartments are ideal for investors and perfect for professionals and families of all sizes to make their home. Only minutes by tube and train from Central London, they couldn't be better connected.

Arranged around a beautifully landscaped 2 acre garden square, New Garden Quarter benefits from facilities that include a 24 hour concierge, residents' gymnasium, proposed nursery, café and other commercial opportunities, as well as the extensive facilities available in fast-growing Stratford itself. Each home is built to the highest standard, creating a unique development in one of London's most talked-about districts.

**CONTEMPORARY
APARTMENTS, VILLAS
AND SKY VILLAS
CENTRED AROUND A
BEAUTIFUL 2 ACRE
GARDEN SQUARE**



STYLISH APARTMENT LIVING WITH A GREENER OUTLOOK

New Garden Quarter integrates elegant modern design with beautifully landscaped public and private green spaces, a proposed nursery & café, residents' gymnasium and the peace of mind of a 24 hour concierge



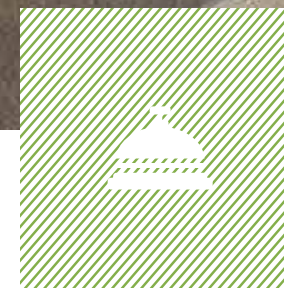

CONCIERGE

A 24 hour concierge service means you'll always be welcomed home and you'll know that security is taken care of.

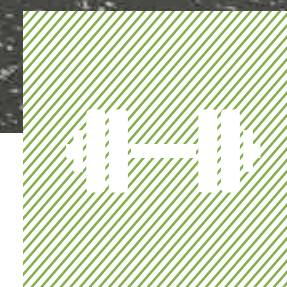
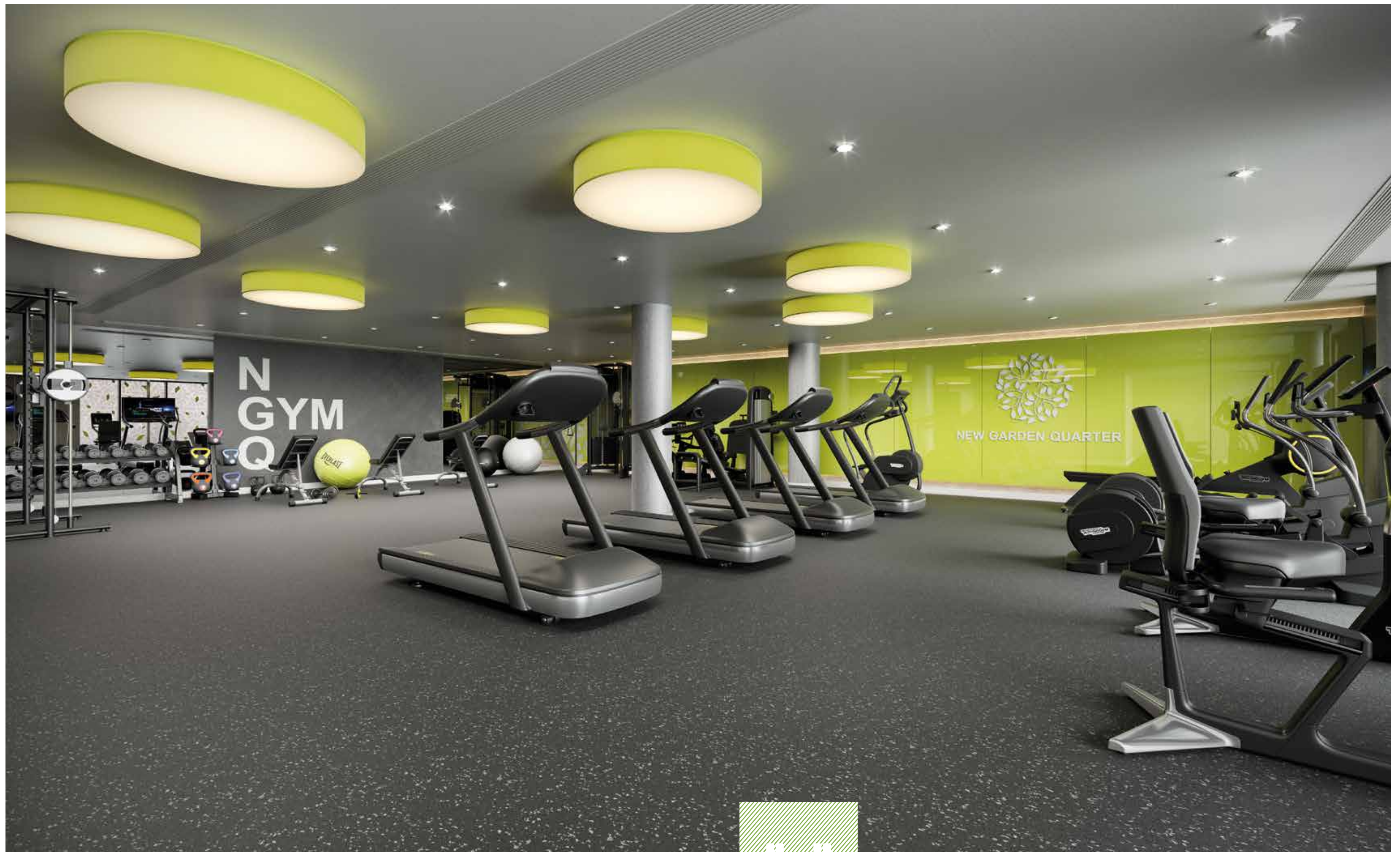

RESIDENTS' GYMNASIUM

Keep fit and healthy in New Garden Quarter's fully equipped residents' gymnasium, stocked with first class exercise equipment.





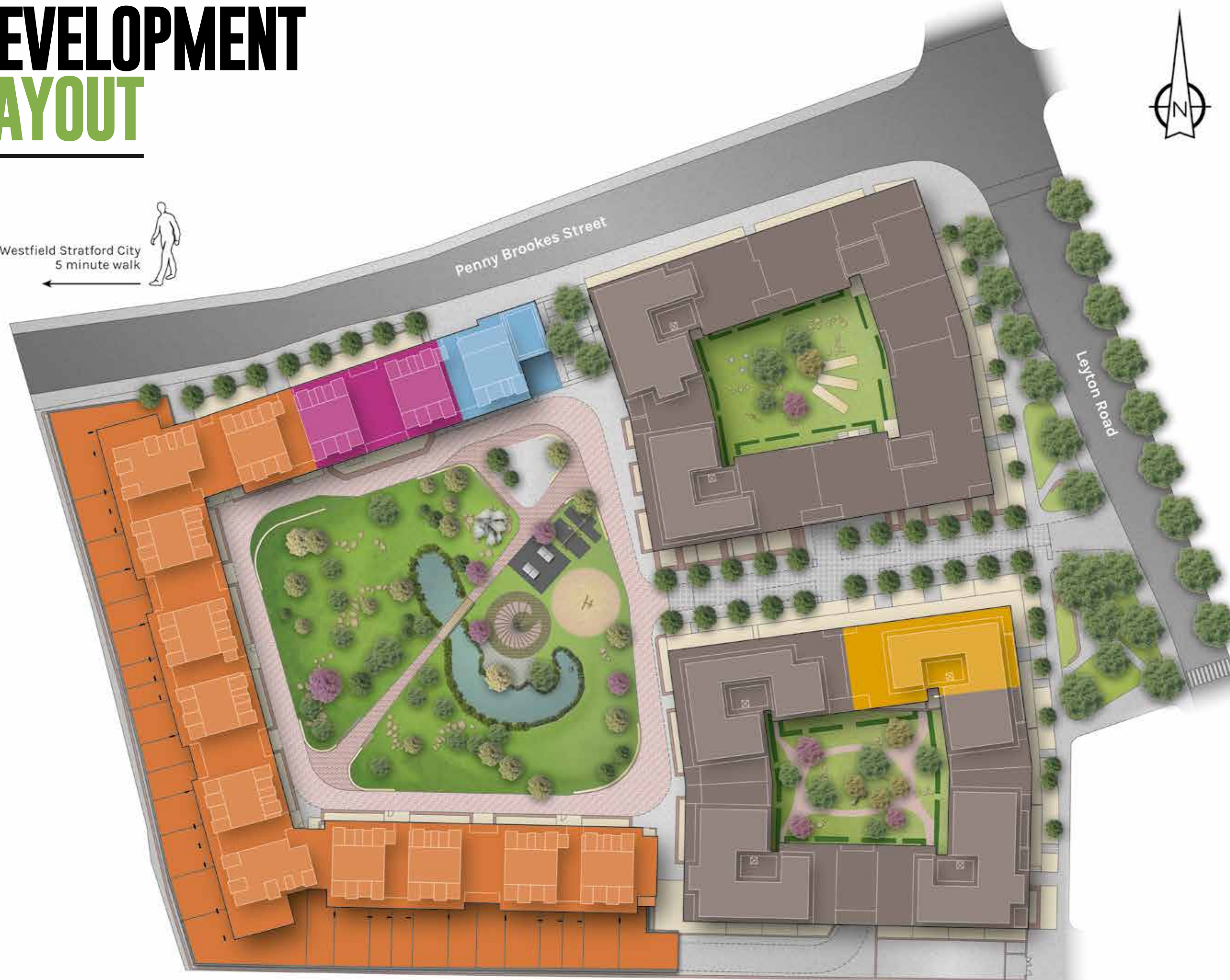
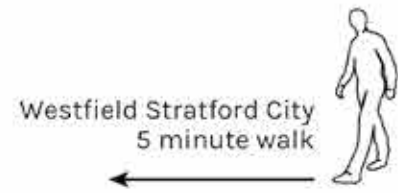

INSPIRED INTERIORS

Each room in your new home has been designed to a high specification, with sleek modern appliances, quality fittings and luxurious underfloor heating. Making the best use of natural light, and using inspired layouts to maximise space, these properties are like a high quality canvas waiting for you to make your very own design impression on them.

DEVELOPMENT LAYOUT



Key

-  Concierge and Gymnasium (Ground Level)
-  Nursery (Ground Level)
-  Café (Ground Level)
Café Terrace (1st Floor)
-  Residential



GROUND FLOOR

WATERMAN HOUSE (CORE P)

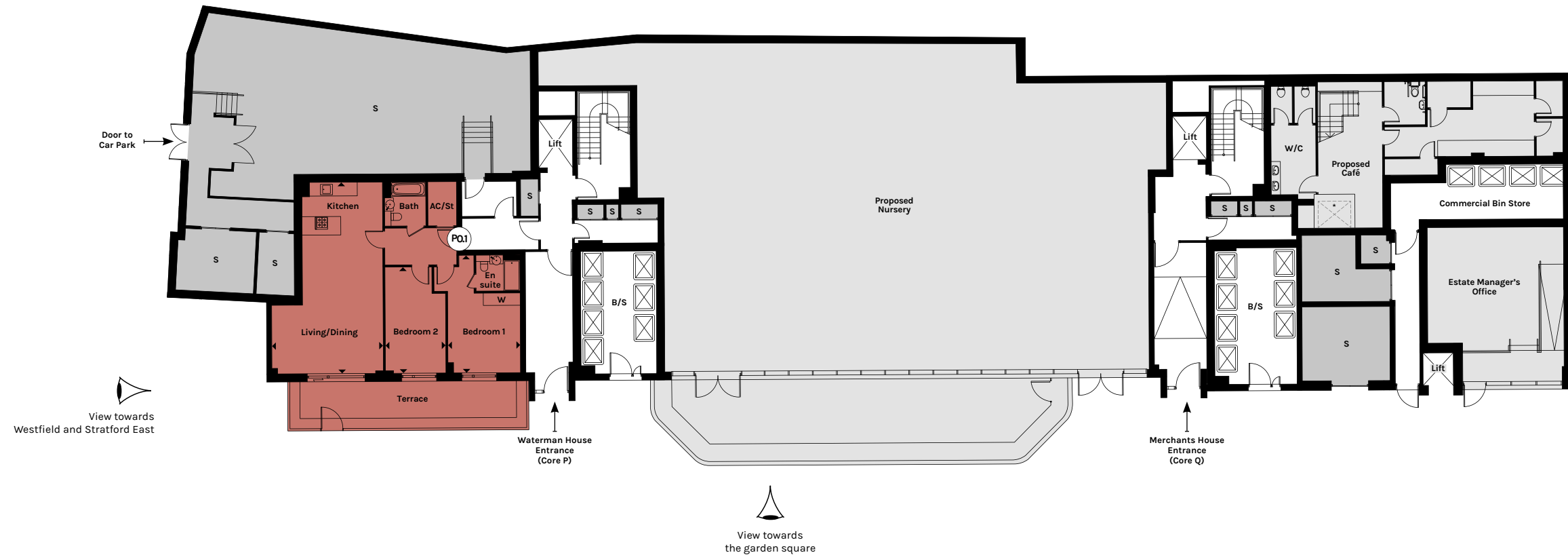

PLOT LOCATION

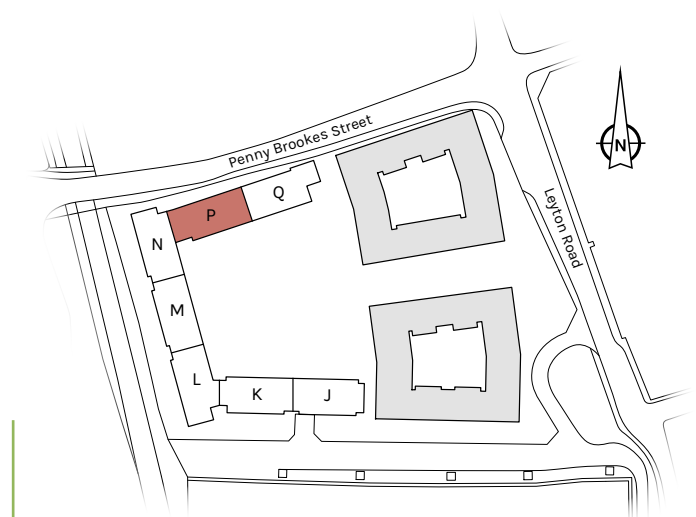

APARTMENT PO.1

KITCHEN/LIVING/DINING	9.33M X 5.44M	30'7" X 17'10"
BEDROOM 1	5.74M X 3.54M	18'10" X 11'7"
BEDROOM 2	5.18M X 2.95M	17'0" X 9'8"
TOTAL AREA	92.9 SQ M	1,000 SQ FT
TERRACE AREA	18.9 SQ M	203 SQ FT

Waterman House

S denotes Services. B/S denotes Bin Store. C/S denotes Cycle Store.

Arrows denote where measurements have been taken from.

We operate a policy of continuous improvement and individual features such as kitchen and bathroom layouts, doors, windows and elevational treatments may vary from time to time. Consequently these particulars should be treated as general guidance only and do not constitute a contract, part of a contract or a warranty. External finishes, landscaping and configuration may vary. Please refer to Sales Advisor for further details. All dimensions are approximate and should not be used for carpet sizes, appliance spaces or furniture. Furniture not to scale and all positions are indicative.



FIRST FLOOR

WATERMAN HOUSE (CORE P) / MERCHANTS HOUSE (CORE Q)

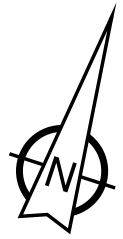

APARTMENT P1.1

KITCHEN/LIVING/DINING	11.69M X 3.86M	38'4" X 12'8"
BEDROOM 1	4.63M X 3.15M	15'2" X 10'4"
BEDROOM 2	4.63M X 2.75M	15'2" X 9'0"
BEDROOM 3	4.26M X 2.05M	14'0" X 6'9"
TOTAL AREA	102.4 SQ M	1,102 SQ FT
TERRACE AREA	27.8 SQ M	299 SQ FT

APARTMENT P1.2

KITCHEN/LIVING/DINING	7.89M X 4.02M	25'11" X 13'2"
BEDROOM	4.48M X 3.03M	14'8" X 9'11"
TOTAL AREA	54.1 SQ M	582 SQ FT

APARTMENT P1.3

KITCHEN/LIVING/DINING	6.86M X 3.90M	22'6" X 12'10"
BEDROOM	4.61M X 3.51M	15'1" X 11'6"
TOTAL AREA	51.5 SQ M	554 SQ FT

APARTMENT P1.4

KITCHEN/LIVING/DINING	7.89M X 4.02M	25'10" X 13'2"
BEDROOM	4.48M X 3.03M	14'8" X 9'11"
TOTAL AREA	54.1 SQ M	582 SQ FT

APARTMENT P1.5

KITCHEN/LIVING/DINING	11.69M X 3.86M	38'4" X 12'8"
BEDROOM 1	4.63M X 3.15M	15'2" X 10'4"
BEDROOM 2	4.63M X 2.75M	15'2" X 9'0"
BEDROOM 3	4.26M X 2.05M	13'12" X 6'9"
TOTAL AREA	101.6 SQ M	1,093 SQ FT
TERRACE AREA	30.5 SQ M	328 SQ FT

APARTMENT Q1.1

KITCHEN/LIVING/DINING	6.86M X 3.90M	22'6" X 12'10"
BEDROOM	4.61M X 3.51M	15'1" X 11'6"
TOTAL AREA	51.5 SQ M	554 SQ FT

APARTMENT Q1.2

KITCHEN/LIVING/DINING	7.89M X 4.02M	25'11" X 13'2"
BEDROOM	4.48M X 3.03M	14'8" X 9'11"
TOTAL AREA	54.1 SQ M	582 SQ FT

APARTMENT Q1.3

KITCHEN/LIVING/DINING	11.69M X 3.86M	38'4" X 12'8"
BEDROOM 1	4.63M X 3.15M	15'2" X 10'4"
BEDROOM 2	4.63M X 2.75M	15'2" X 9'0"
BEDROOM 3	4.26M X 2.05M	14'0" X 6'9"
TOTAL AREA	101.5 SQ M	1,092 SQ FT
TERRACE AREA	26.8 SQ M	288 SQ FT

Arrows denote where measurements have been taken from.

We operate a policy of continuous improvement and individual features such as kitchen and bathroom layouts, doors, windows and elevational treatments may vary from time to time. Consequently these particulars should be treated as general guidance only and do not constitute a contract, part of a contract or a warranty. External finishes, landscaping and configuration may vary. Please refer to Sales Advisor for further details. All dimensions are approximate and should not be used for carpet sizes, appliance spaces or furniture. Furniture not to scale and all positions are indicative.

Waterman House Merchants House

S denotes Services. B/S denotes Bin Store. C/S denotes Cycle Store.

PLOT LOCATION

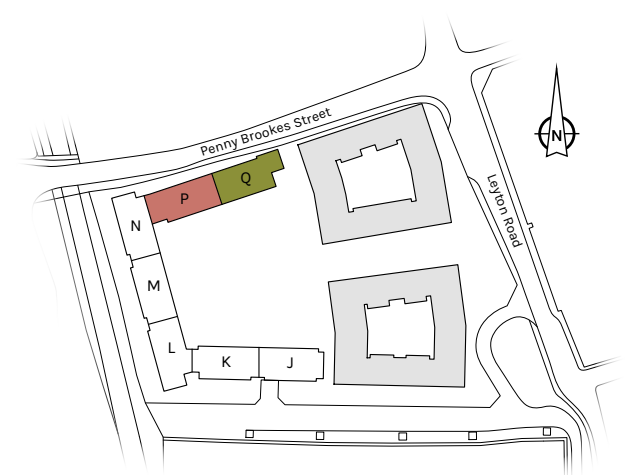



SECOND FLOOR

WATERMAN HOUSE (CORE P) / MERCHANTS HOUSE (CORE Q)

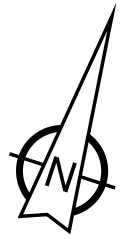

APARTMENT P2.1

KITCHEN/LIVING/DINING	11.69M X 3.86M	38'4" X 12'8"
BEDROOM 1	4.63M X 3.15M	15'2" X 10'4"
BEDROOM 2	4.63M X 2.75M	15'2" X 9'0"
BEDROOM 3	4.26M X 2.05M	14'0" X 6'9"
TOTAL AREA	102.3 SQ M	1,101 SQ FT

APARTMENT P2.2

KITCHEN/LIVING/DINING	7.89M X 4.02M	25'11" X 13'2"
BEDROOM	4.48M X 3.03M	14'8" X 9'11"
TOTAL AREA	54.1 SQ M	582 SQ FT

APARTMENT P2.3

KITCHEN/LIVING/DINING	6.86M X 3.90M	22'6" X 12'10"
BEDROOM	4.61M X 3.51M	15'1" X 11'6"
TOTAL AREA	51.6 SQ M	555 SQ FT

APARTMENT P2.4

KITCHEN/LIVING/DINING	7.89M X 4.02M	25'11" X 13'2"
BEDROOM	4.48M X 3.03M	14'8" X 9'11"
TOTAL AREA	54.1 SQ M	582 SQ FT

APARTMENT P2.5

KITCHEN/LIVING/DINING	11.69M X 3.86M	38'4" X 12'8"
BEDROOM 1	4.63M X 3.15M	15'2" X 10'4"
BEDROOM 2	4.63M X 2.75M	15'2" X 9'0"
BEDROOM 3	4.26M X 2.05M	14'0" X 6'9"
TOTAL AREA	101.6 SQ M	1,093 SQ FT

APARTMENT Q2.1

KITCHEN/LIVING/DINING	6.85M X 6.00M	22'6" X 19'8"
BEDROOM 1	4.65M X 3.06M	15'3" X 10'0"
BEDROOM 2	4.65M X 2.80M	15'3" X 9'2"
BEDROOM 3	5.89M X 2.06M	19'4" X 6'9"
TOTAL AREA	97.7 SQ M	1,051 SQ FT

APARTMENT Q2.2

KITCHEN/LIVING/DINING	8.68M X 4.46M	28'6" X 14'8"
BEDROOM	4.54M X 2.91M	14'11" X 9'7"
TOTAL AREA	59.4 SQ M	639 SQ FT

APARTMENT Q2.3

KITCHEN/LIVING/DINING	6.86M X 3.90M	22'6" X 12'10"
BEDROOM	4.61M X 3.51M	15'2" X 10'4"
TOTAL AREA	51.5 SQ M	554 SQ FT

APARTMENT Q2.4

KITCHEN/LIVING/DINING	7.89M X 4.11M	25'11" X 13'6"
BEDROOM	4.48M X 3.03M	14'8" X 9'11"
TOTAL AREA	54.1 SQ M	582 SQ FT

APARTMENT Q2.5

KITCHEN/LIVING/DINING	11.69M X 3.86M	38'4" X 12'8"
BEDROOM 1	4.63M X 3.15M	15'2" X 10'4"
BEDROOM 2	4.63M X 2.75M	15'2" X 9'0"
BEDROOM 3	4.26M X 2.05M	14'0" X 6'9"
TOTAL AREA	101.6 SQ M	1,093 SQ FT

PLOT LOCATION

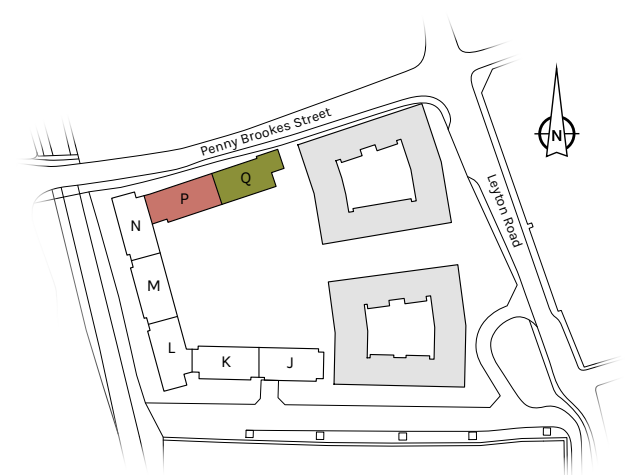

Waterman House Merchants House

S denotes Services. B/S denotes Bin Store. C/S denotes Cycle Store.

Arrows denote where measurements have been taken from.

We operate a policy of continuous improvement and individual features such as kitchen and bathroom layouts, doors, windows and elevational treatments may vary from time to time. Consequently these particulars should be treated as general guidance only and do not constitute a contract, part of a contract or a warranty. External finishes, landscaping and configuration may vary. Please refer to Sales Advisor for further details. All dimensions are approximate and should not be used for carpet sizes, appliance spaces or furniture. Furniture not to scale and all positions are indicative.



THIRD FLOOR

WATERMAN HOUSE (CORE P) / MERCHANTS HOUSE (CORE Q)



APARTMENT P3.1

KITCHEN/LIVING/DINING	11.69M X 3.86M	38'4" X 12'8"
BEDROOM 1	4.63M X 3.15M	15'2" X 10'4"
BEDROOM 2	4.63M X 2.75M	15'2" X 9'0"
BEDROOM 3	4.26M X 2.05M	14'0" X 6'9"
TOTAL AREA	102.4 SQ M	1,102 SQ FT

APARTMENT P3.2

KITCHEN/LIVING/DINING	7.89M X 4.03M	25'11" X 13'3"
BEDROOM	4.48M X 3.03M	14'8" X 9'11"
TOTAL AREA	54.2 SQ M	583 SQ FT

APARTMENT P3.3

KITCHEN/LIVING/DINING	6.86M X 3.90M	22'6" X 12'10"
BEDROOM	4.61M X 3.51M	15'2" X 11'6"
TOTAL AREA	51.5 SQ M	554 SQ FT

APARTMENT P3.4

KITCHEN/LIVING/DINING	7.89M X 4.03M	25'11" X 13'3"
BEDROOM	4.48M X 3.03M	14'8" X 9'11"
TOTAL AREA	54.2 SQ M	583 SQ FT

APARTMENT P3.5

KITCHEN/LIVING/DINING	11.69M X 3.86M	38'4" X 12'8"
BEDROOM 1	4.63M X 3.15M	15'2" X 10'4"
BEDROOM 2	4.63M X 2.75M	15'2" X 9'0"
BEDROOM 3	4.26M X 2.05M	14'0" X 6'9"
TOTAL AREA	101.6 SQ M	1,094 SQ FT

APARTMENT Q3.1

KITCHEN/LIVING/DINING	6.85M X 6.00M	22'6" X 19'8"
BEDROOM 1	4.65M X 3.06M	15'3" X 10'0"
BEDROOM 2	4.65M X 2.80M	15'3" X 9'2"
BEDROOM 3	5.89M X 2.06M	19'4" X 6'9"
TOTAL AREA	97.7 SQ M	1,052 SQ FT

APARTMENT Q3.2

KITCHEN/LIVING/DINING	8.68M X 4.46M	28'6" X 14'6"
BEDROOM	4.54M X 2.91M	14'11" X 9'7"
TOTAL AREA	59.3 SQ M	638 SQ FT

APARTMENT Q3.3

KITCHEN/LIVING/DINING	6.86M X 3.90M	22'6" X 12'10"
BEDROOM	4.61M X 3.51M	15'2" X 11'6"
TOTAL AREA	51.5 SQ M	554 SQ FT

APARTMENT Q3.4

KITCHEN/LIVING/DINING	7.89M X 4.03M	25'11" X 13'3"
BEDROOM	4.48M X 3.03M	14'8" X 9'11"
TOTAL AREA	54.2 SQ M	583 SQ FT

APARTMENT Q3.5

KITCHEN/LIVING/DINING	11.69M X 3.86M	38'4" X 12'8"
BEDROOM 1	4.63M X 3.15M	15'2" X 10'4"
BEDROOM 2	4.63M X 2.75M	15'2" X 9'0"
BEDROOM 3	4.26M X 2.05M	14'0" X 6'9"
TOTAL AREA	101.6 SQ M	1,094 SQ FT

PLOT LOCATION

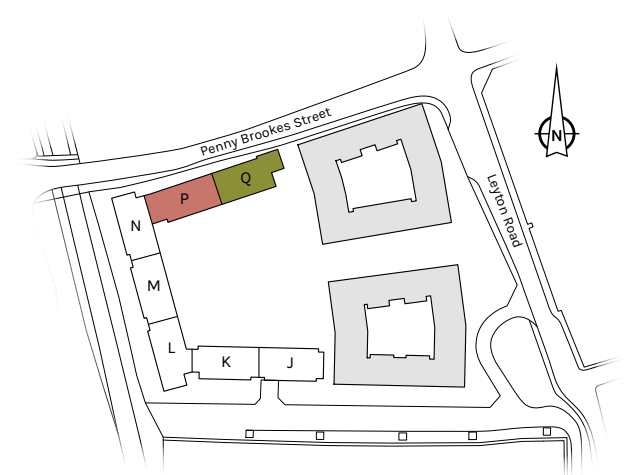

Arrows denote where measurements have been taken from.

We operate a policy of continuous improvement and individual features such as kitchen and bathroom layouts, doors, windows and elevational treatments may vary from time to time. Consequently these particulars should be treated as general guidance only and do not constitute a contract, part of a contract or a warranty. External finishes, landscaping and configuration may vary. Please refer to Sales Advisor for further details. All dimensions are approximate and should not be used for carpet sizes, appliance spaces or furniture. Furniture not to scale and all positions are indicative.

Waterman House Merchants House

S denotes Services. B/S denotes Bin Store. C/S denotes Cycle Store.



FOURTH FLOOR

WATERMAN HOUSE (CORE P) / MERCHANTS HOUSE (CORE Q)



APARTMENT P4.1

KITCHEN/LIVING/DINING	11.69M X 3.86M	38'4" X 12'8"
BEDROOM 1	4.63M X 3.15M	15'2" X 10'4"
BEDROOM 2	4.63M X 2.75M	15'2" X 9'0"
BEDROOM 3	4.26M X 2.85M	14'0" X 6'9"
TOTAL AREA	102.4 SQ M	1,102 SQ FT

APARTMENT P4.2

KITCHEN/LIVING/DINING	7.89M X 4.03M	25'11" X 13'3"
BEDROOM	4.48M X 3.03M	14'8" X 9'11"
TOTAL AREA	54.2 SQ M	583 SQ FT

APARTMENT P4.3

KITCHEN/LIVING/DINING	6.86M X 3.90M	22'6" X 12'10"
BEDROOM	4.61M X 3.51M	15'2" X 11'6"
TOTAL AREA	51.5 SQ M	554 SQ FT

APARTMENT P4.4

KITCHEN/LIVING/DINING	7.89M X 4.03M	25'11" X 13'3"
BEDROOM	4.48M X 3.03M	14'8" X 9'11"
TOTAL AREA	54.2 SQ M	583 SQ FT

APARTMENT P4.5

KITCHEN/LIVING/DINING	11.69M X 3.86M	38'4" X 12'8"
BEDROOM 1	4.63M X 3.15M	15'2" X 10'4"
BEDROOM 2	4.63M X 2.75M	15'2" X 9'0"
BEDROOM 3	4.26M X 2.05M	14'0" X 6'9"
TOTAL AREA	101.6 SQ M	1,094 SQ FT

APARTMENT Q4.1

KITCHEN/LIVING/DINING	6.85M X 6.00M	22'6" X 19'8"
BEDROOM 1	4.65M X 3.06M	15'3" X 10'0"
BEDROOM 2	4.65M X 2.80M	15'3" X 9'2"
BEDROOM 3	5.89M X 2.06M	19'4" X 6'9"
TOTAL AREA	97.7 SQ M	1,052 SQ FT

APARTMENT Q4.2

KITCHEN/LIVING/DINING	8.68 X 4.46M	28'6" X 14'6"
BEDROOM	4.54M X 2.91M	14'11" X 9'7"
TOTAL AREA	59.3 SQ M	638 SQ FT

APARTMENT Q4.3

KITCHEN/LIVING/DINING	6.86M X 3.90M	22'6" X 12'10"
BEDROOM	4.61M X 3.51M	15'2" X 11'6"
TOTAL AREA	51.5 SQ M	554 SQ FT

APARTMENT Q4.4

KITCHEN/LIVING/DINING	7.89M X 4.03M	25'11" X 13'3"
BEDROOM	4.48M X 3.03M	14'8" X 9'11"
TOTAL AREA	54.2 SQ M	583 SQ FT

APARTMENT Q4.5

KITCHEN/LIVING/DINING	11.69M X 3.86M	38'4" X 12'8"
BEDROOM 1	4.63M X 3.15M	15'2" X 10'4"
BEDROOM 2	4.63M X 2.75M	15'2" X 9'0"
BEDROOM 3	4.26M X 2.05M	14'0" X 6'9"
TOTAL AREA	101.6 SQ M	1,094 SQ FT

PLOT LOCATION

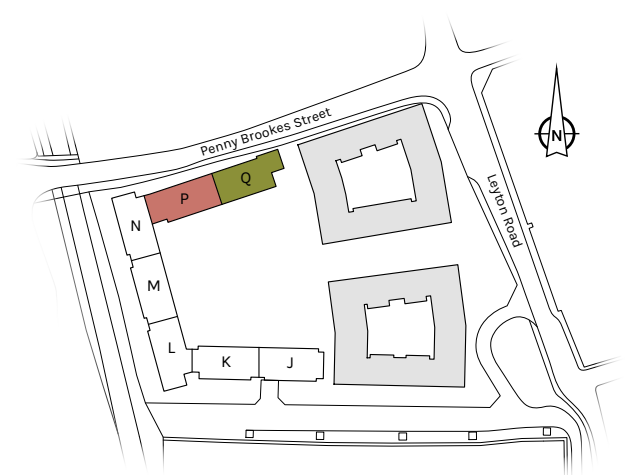

Arrows denote where measurements have been taken from.

We operate a policy of continuous improvement and individual features such as kitchen and bathroom layouts, doors, windows and elevational treatments may vary from time to time. Consequently these particulars should be treated as general guidance only and do not constitute a contract, part of a contract or a warranty. External finishes, landscaping and configuration may vary. Please refer to Sales Advisor for further details. All dimensions are approximate and should not be used for carpet sizes, appliance spaces or furniture. Furniture not to scale and all positions are indicative.

Waterman House Merchants House

S denotes Services. B/S denotes Bin Store. C/S denotes Cycle Store.



FIFTH FLOOR

WATERMAN HOUSE (CORE P) / MERCHANTS HOUSE (CORE Q)



APARTMENT P5.1

KITCHEN/LIVING/DINING	11.69M X 3.86M	38'4" X 12'8"
BEDROOM 1	4.63M X 3.15M	15'2" X 10'4"
BEDROOM 2	4.63M X 2.75M	15'2" X 9'0"
BEDROOM 3	4.26M X 2.05M	14'0" X 6'9"
TOTAL AREA	102.4 SQ M	1,102 SQ FT

APARTMENT P5.2

KITCHEN/LIVING/DINING	7.89M X 4.03M	25'11" X 13'3"
BEDROOM	4.48M X 3.03M	14'8" X 9'11"
TOTAL AREA	54.2 SQ M	583 SQ FT

APARTMENT P5.3

KITCHEN/LIVING/DINING	6.86M X 3.90M	22'6" X 12'10"
BEDROOM	4.61M X 3.51M	15'2" X 11'6"
TOTAL AREA	51.5 SQ M	554 SQ FT

APARTMENT P5.4

KITCHEN/LIVING/DINING	7.89M X 4.03M	25'11" X 13'3"
BEDROOM	4.48M X 3.03M	14'8" X 9'11"
TOTAL AREA	54.2 SQ M	583 SQ FT

APARTMENT P5.5

KITCHEN/LIVING/DINING	11.69M X 3.86M	38'4" X 12'8"
BEDROOM 1	4.63M X 3.15M	15'2" X 10'4"
BEDROOM 2	4.63M X 2.75M	15'2" X 9'0"
BEDROOM 3	4.26M X 2.05M	14'0" X 6'9"
TOTAL AREA	101.6 SQ M	1,094 SQ FT

APARTMENT Q5.1

KITCHEN/LIVING/DINING	6.85M X 6.00M	22'6" X 19'8"
BEDROOM 1	4.65M X 3.06M	15'3" X 10'0"
BEDROOM 2	4.65M X 2.80M	15'3" X 9'2"
BEDROOM 3	5.89M X 2.06M	19'4" X 6'9"
TOTAL AREA	97.7 SQ M	1,052 SQ FT

APARTMENT Q5.2

KITCHEN/LIVING/DINING	8.68 X 4.46M	28'6" X 14'6"
BEDROOM	4.54M X 2.91M	14'11" X 9'7"
TOTAL AREA	59.3 SQ M	638 SQ FT

APARTMENT Q5.3

KITCHEN/LIVING/DINING	6.86M X 3.90M	22'6" X 12'10"
BEDROOM	4.61M X 3.51M	15'2" X 11'6"
TOTAL AREA	51.5 SQ M	554 SQ FT

APARTMENT Q5.4

KITCHEN/LIVING/DINING	7.89M X 4.03M	25'11" X 13'3"
BEDROOM	4.48M X 3.03M	14'8" X 9'11"
TOTAL AREA	54.2 SQ M	583 SQ FT

APARTMENT Q5.5

KITCHEN/LIVING/DINING	11.69M X 3.86M	38'4" X 12'8"
BEDROOM 1	4.63M X 3.15M	15'2" X 10'4"
BEDROOM 2	4.63M X 2.75M	15'2" X 9'0"
BEDROOM 3	4.26M X 2.05M	14'0" X 6'9"
TOTAL AREA	101.6 SQ M	1,094 SQ FT

PLOT LOCATION



Arrows denote where measurements have been taken from.

We operate a policy of continuous improvement and individual features such as kitchen and bathroom layouts, doors, windows and elevational treatments may vary from time to time. Consequently these particulars should be treated as general guidance only and do not constitute a contract, part of a contract or a warranty. External finishes, landscaping and configuration may vary. Please refer to Sales Advisor for further details. All dimensions are approximate and should not be used for carpet sizes, appliance spaces or furniture. Furniture not to scale and all positions are indicative.

Waterman House Merchants House

S denotes Services. B/S denotes Bin Store. C/S denotes Cycle Store.



SIXTH FLOOR

WATERMAN HOUSE (CORE P) / MERCHANTS HOUSE (CORE Q)



APARTMENT P6.1 (Dual Level Sky Villa)

KITCHEN/LIVING/DINING	8.53M X 4.21M	27'11" X 13'10"
TERRACE AREA	37.5 SQ M	404 SQ FT

APARTMENT P6.2 (Dual Level Sky Villa)

KITCHEN/LIVING/DINING	6.90M X 5.50M	22'8" X 18'1"
BEDROOM 3	3.93M X 2.60M	12'11" X 8'6"
TERRACE AREA	32.6 SQ M	351 SQ FT

APARTMENT P6.3 (Dual Level Sky Villa)

KITCHEN/LIVING/DINING	6.90M X 5.50M	22'8" X 18'1"
BEDROOM 3	3.93M X 2.60M	12'11" X 8'6"
TERRACE AREA	41.5 SQ M	447 SQ FT

APARTMENT P6.4 (Dual Level Sky Villa)

KITCHEN/LIVING/DINING	8.52M X 6.62M	27'11" X 21'9"
TERRACE AREA	36.2 SQ M	390 SQ FT

APARTMENT Q6.1 (Dual Level Sky Villa)

KITCHEN/LIVING/DINING	6.85M X 4.44M	22'7" X 14'7"
-----------------------	---------------	---------------

APARTMENT Q6.2 (Dual Level Sky Villa)

KITCHEN/LIVING/DINING	7.33M X 5.50M	24'1" X 18'1"
BEDROOM 3	3.93M X 2.61M	12'11" X 8'6"
TERRACE AREA	13.3 SQ M	143 SQ FT

APARTMENT Q6.3 (Dual Level Sky Villa)

KITCHEN/LIVING/DINING	6.90M X 5.50M	22'8" X 18'1"
BEDROOM 3	3.93M X 2.61M	12'11" X 8'6"
TERRACE AREA	41.5 SQ M	447 SQ FT

APARTMENT Q6.4 (Dual Level Sky Villa)

KITCHEN/LIVING/DINING	8.52M X 6.62M	27'11" X 21'9"
TERRACE AREA	36.8 SQ M	396 SQ FT

APARTMENT Q6.5 (Dual Level Sky Villa)

BEDROOM 1	4.10M X 3.55M	13'6" X 11'8"
BEDROOM 2	4.81M X 2.94M	15'9" X 9'8"

Arrows denote where measurements have been taken from.

We operate a policy of continuous improvement and individual features such as kitchen and bathroom layouts, doors, windows and elevational treatments may vary from time to time. Consequently these particulars should be treated as general guidance only and do not constitute a contract, part of a contract or a warranty. External finishes, landscaping and configuration may vary. Please refer to Sales Advisor for further details. All dimensions are approximate and should not be used for carpet sizes, appliance spaces or furniture. Furniture not to scale and all positions are indicative.

Waterman House Merchants House

S denotes Services. B/S denotes Bin Store. C/S denotes Cycle Store.

PLOT LOCATION

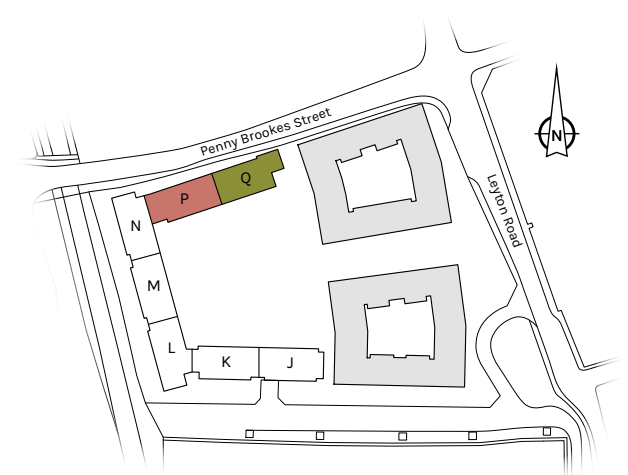



SEVENTH FLOOR

WATERMAN HOUSE (CORE P) / MERCHANTS HOUSE (CORE Q)



APARTMENT P6.1 (Dual Level Sky Villa)

BEDROOM 1	4.12M X 2.89M	13'6" X 9'6"
BEDROOM 2	4.12M X 2.38M	13'6" X 7'10"
BEDROOM 3	3.87M X 3.14M	12'8" X 10'4"
TOTAL AREA	98.4 SQ M	1,059 SQ FT

APARTMENT P6.2 (Dual Level Sky Villa)

BEDROOM 1	5.21M X 3.27M	17'1" X 10'9"
BEDROOM 2	4.40M X 3.30M	14'5" X 10'10"
TOTAL AREA	98.1 SQ M	1,056 SQ FT

APARTMENT P6.3 (Dual Level Sky Villa)

BEDROOM 1	5.21M X 3.27M	17'1" X 10'9"
BEDROOM 2	4.40M X 3.30M	14'5" X 10'10"
TOTAL AREA	98.1 SQ M	1,056 SQ FT

APARTMENT P6.4 (Dual Level Sky Villa)

BEDROOM 1	4.37M X 3.30M	14'4" X 10'10"
BEDROOM 2	4.51M X 2.93M	14'10" X 9'7"
BEDROOM 3	3.14M X 1.97M	10'4" X 6'6"
TOTAL AREA	98.3 SQ M	1,058 SQ FT

APARTMENT Q6.1 (Dual Level Sky Villa)

BEDROOM 1	4.82M X 3.49M	15'10" X 11'5"
BEDROOM 2	3.85M X 3.49M	12'7" X 11'5"
TOTAL AREA	96.3 SQ M	1,036 SQ FT

APARTMENT Q6.2 (Dual Level Sky Villa)

BEDROOM 1	5.23M X 3.25M	17'7" X 10'8"
BEDROOM 2	4.40M X 3.71M	14'5" X 12'2"
TOTAL AREA	102.7 SQ M	1,105 SQ FT

APARTMENT Q6.3 (Dual Level Sky Villa)

BEDROOM 1	5.21M X 3.25M	17'1" X 10'8"
BEDROOM 2	4.40M X 3.30M	14'5" X 10'10"
TOTAL AREA	98.0 SQ M	1,054 SQ FT

APARTMENT Q6.4 (Dual Level Sky Villa)

BEDROOM 1	4.37M X 3.30M	14'4" X 10'10"
BEDROOM 2	4.51M X 2.92M	14'10" X 9'7"
BEDROOM 3	3.15M X 1.97M	10'4" X 6'6"
TOTAL AREA	98.5 SQ M	1,060 SQ FT

APARTMENT Q6.5 (Dual Level Sky Villa)

KITCHEN/LIVING/DINING	8.61M X 6.62M	28'3" X 21'9"
TOTAL AREA	98.8 SQ M	1,063 SQ FT

PLOT LOCATION

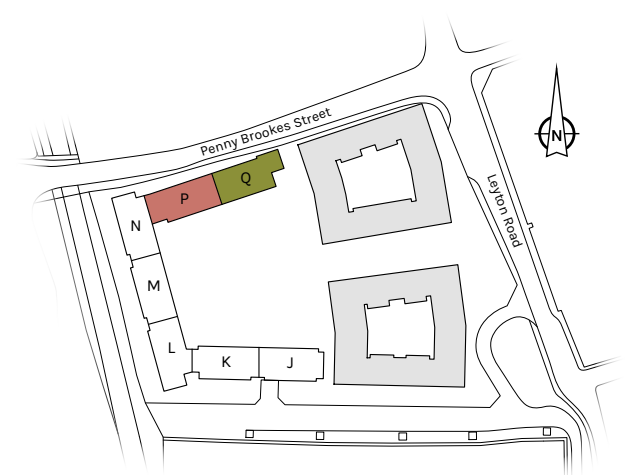

Waterman House Merchants House

Arrows denote where measurements have been taken from. --- Reduced Head Height.

We operate a policy of continuous improvement and individual features such as kitchen and bathroom layouts, doors, windows and elevational treatments may vary from time to time. Consequently these particulars should be treated as general guidance only and do not constitute a contract, part of a contract or a warranty. External finishes, landscaping and configuration may vary. Please refer to Sales Advisor for further details. All dimensions are approximate and should not be used for carpet sizes, appliance spaces or furniture. Furniture not to scale and all positions are indicative.

S denotes Services. B/S denotes Bin Store. C/S denotes Cycle Store.



GROUND FLOOR

AVENIR HOUSE (CORE N) / GILES HOUSE (CORE M) / HAWTHORN HOUSE (CORE L)



APARTMENT NO.1 (Dual Level Villa)

BEDROOM 1	6.47M X 3.65M	21'3" X 12'0"
BEDROOM 2	3.97M X 3.61M	13'0" X 11'10"
BEDROOM 3	3.97M X 3.62M	13'0" X 11'11"
TERRACE LOWER	15.8 SQ M	170 SQ FT

APARTMENT MO.1 (Dual Level Villa)

KITCHEN/DINING	5.01M X 2.85M	16'5" X 9'4"
BEDROOM 1	6.47M X 2.94M	21'3" X 9'8"
BEDROOM 2	4.37M X 2.80M	14'4" X 9'2"
BEDROOM 3	4.37M X 2.16M	14'4" X 7'1"
TERRACE AREA	18.6 SQ M	200 SQ FT

APARTMENT MO.2 (Dual Level Villa)

KITCHEN/DINING	5.20M X 2.85M	17'1" X 9'4"
BEDROOM 1	6.47M X 2.94M	21'3" X 9'8"
BEDROOM 2	4.37M X 2.80M	14'4" X 9'2"
BEDROOM 3	4.37M X 2.16M	14'4" X 7'1"
TERRACE AREA	14.7 SQ M	158 SQ FT

APARTMENT LO.1 (Dual Level Villa)

BEDROOM 1	6.47M X 3.65M	21'3" X 12'0"
BEDROOM 2	3.95M X 3.61M	13'0" X 11'10"
BEDROOM 3	3.97M X 3.62M	13'0" X 11'11"
TERRACE AREA	15.8 SQ M	170 SQ FT

PLOT LOCATION



■ Avenir House ■ Giles House ■ Hawthorn House

S denotes Services. B/S denotes Bin Store. C/S denotes Cycle Store. M/S denotes Motorbike Spaces.

Arrows denote where measurements have been taken from.

We operate a policy of continuous improvement and individual features such as kitchen and bathroom layouts, doors, windows and elevational treatments may vary from time to time. Consequently these particulars should be treated as general guidance only and do not constitute a contract, part of a contract or a warranty. External finishes, landscaping and configuration may vary. Please refer to Sales Advisor for further details. All dimensions are approximate and should not be used for carpet sizes, appliance spaces or furniture. Furniture not to scale and all positions are indicative.



FIRST FLOOR

AVENIR HOUSE (CORE N) / GILES HOUSE (CORE M) / HAWTHORN HOUSE (CORE L)



View towards Central London

View towards Westfield and Stratford East

APARTMENT NO.1 (Dual Level Villa)

KITCHEN/LIVING/DINING	7.51M X 6.86M	24'8" X 22'6"
TOTAL AREA	131.8 SQ M	1,419 SQ FT
TERRACE UPPER	58.2 SQ M	626 SQ FT

APARTMENT N1.1

KITCHEN/LIVING/DINING	10.11M X 3.86M	33'2" X 12'8"
BEDROOM 1	4.59M X 2.91M	15'1" X 9'7"
BEDROOM 2	3.89M X 2.90M	12'9" X 9'6"
BEDROOM 3	3.89M X 2.17M	12'9" X 9'7"
TOTAL AREA	96.0 SQ M	1,033 SQ FT
TERRACE AREA	46.5 SQ M	501 SQ FT

APARTMENT N1.2 (Dual Level Villa)

KITCHEN/LIVING/DINING	7.89M X 4.96M	25'11" X 16'3"
TERRACE AREA	46.3 SQ M	498 SQ FT

APARTMENT N1.3

KITCHEN/LIVING/DINING	8.04M X 6.52M	21'5" X 17'3"
BEDROOM 1	7.91M X 3.82M	25'11" X 12'6"
BEDROOM 2	5.26M X 3.05M	17'3" X 10'0"
BEDROOM 3	4.23M X 3.95M	13'11" X 13'0"
TOTAL AREA	132.7 SQ M	1,428 SQ FT
TERRACE AREA	170 SQ M	1829 SQ FT

APARTMENT MO.1 (Dual Level Villa)

LIVING	5.86M X 3.62M	19'3" X 11'11"
TOTAL AREA	104.6 SQ M	1,126 SQ FT
TERRACE UPPER	26.9 SQ M	290 SQ FT

APARTMENT MO.2 (Dual Level Villa)

LIVING	5.86M X 3.62M	19'3" X 11'11"
TOTAL AREA	106.4 SQ M	1,145 SQ FT
TERRACE UPPER	28.3 SQ M	305 SQ FT

APARTMENT M1.1

KITCHEN/LIVING/DINING	10.11M X 3.86M	33'2" X 12'8"
BEDROOM 1	4.62M X 3.15M	15'2" X 10'4"
BEDROOM 2	4.62M X 2.75M	15'2" X 9'0"
BEDROOM 3	4.26M X 2.07M	14'0" X 6'9"
TOTAL AREA	96.2 SQ M	1,035 SQ FT
TERRACE AREA	46.9 SQ M	505 SQ FT

APARTMENT M1.2 (Dual Level Villa)

KITCHEN/LIVING/DINING	7.89M X 4.96M	25'11" X 16'3"
TERRACE AREA	46.1 SQ M	496 SQ FT

APARTMENT M1.3 (Dual Level Villa)

KITCHEN/LIVING/DINING	7.89M X 4.96M	25'11" X 16'3"
TERRACE AREA	44.3 SQ M	476 SQ FT

APARTMENT M1.4

KITCHEN/LIVING/DINING	10.11M X 3.86M	33'2" X 12'8"
BEDROOM 1	4.62M X 3.15M	15'2" X 10'4"
BEDROOM 2	4.62M X 2.75M	15'2" X 9'0"
BEDROOM 3	4.26M X 2.07M	14'0" X 6'9"
TOTAL AREA	95.3 SQ M	1,025 SQ FT
TERRACE AREA	45.6 SQ M	487 SQ FT

APARTMENT LO.1 (Dual Level Villa)

KITCHEN/LIVING/DINING	7.51M X 6.86M	24'8" X 22'6"
TOTAL AREA	131.6 SQ M	1,417 SQ FT
TERRACE UPPER	65.9 SQ M	709 SQ FT

APARTMENT L1.1

KITCHEN/LIVING/DINING	7.71M X 5.31M	25'4" X 17'5"
BEDROOM 1	5.02M X 4.03M	16'6" X 13'3"
BEDROOM 2	4.08M X 3.71M	13'5" X 12'2"
BEDROOM 3	3.89M X 2.75M	12'9" X 9'0"
TOTAL AREA	115.1 SQ M	1,238 SQ FT
TERRACE AREA	173 SQ M	1,862 SQ FT

APARTMENT L1.2 (Dual Level Villa)

KITCHEN/LIVING/DINING	7.89M X 4.96M	25'11" X 16'3"
TERRACE AREA	65.3 SQ M	702 SQ FT

APARTMENT L1.3 (Dual Level Villa)

KITCHEN/LIVING/DINING	7.90M X 4.96M	25'11" X 16'3"
TERRACE AREA	49.5 SQ M	532 SQ FT

APARTMENT L1.4

KITCHEN/LIVING/DINING	10.11M X 3.86M	33'2" X 12'8"
BEDROOM 1	4.59M X 2.91M	15'1" X 9'7"
BEDROOM 2	3.89M X 2.90M	12'9" X 9'6"
BEDROOM 3	3.89M X 2.17M	12'9" X 7'11"
TOTAL AREA	96.3 SQ M	1,036 SQ FT
TERRACE AREA	47.7 SQ M	513 SQ M

PLOT LOCATION

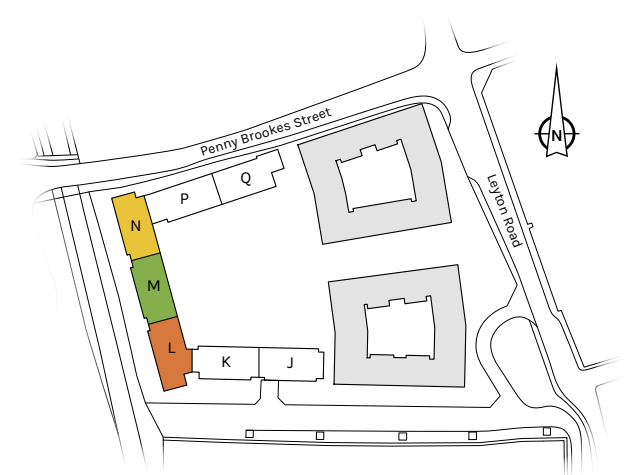

■ Avenir House ■ Giles House ■ Hawthorn House

Arrows denote where measurements have been taken from.

We operate a policy of continuous improvement and individual features such as kitchen and bathroom layouts, doors, windows and elevational treatments may vary from time to time. Consequently these particulars should be treated as general guidance only and do not constitute a contract, part of a contract or a warranty. External finishes, landscaping and configuration may vary. Please refer to Sales Advisor for further details. All dimensions are approximate and should not be used for carpet sizes, appliance spaces or furniture. Furniture not to scale and all positions are indicative.

S denotes Services. B/S denotes Bin Store. C/S denotes Cycle Store.



SECOND FLOOR

AVENIR HOUSE (CORE N) / GILES HOUSE (CORE M) / HAWTHORN HOUSE (CORE L)



APARTMENT N1.2 (Dual Level Villa)

BEDROOM 1	5.31M X 2.75M	17'5" X 9'0"
BEDROOM 2	4.19M X 2.91M	13'9" X 9'7"
BEDROOM 3	4.19M X 2.00M	13'9" X 6'7"
TOTAL AREA	108.7 SQ M	1,170 SQ FT

APARTMENT N2.1

KITCHEN/LIVING/DINING	10.11M X 3.86M	33'2" X 12'8"
BEDROOM 1	4.59M X 2.91M	15'1" X 9'7"
BEDROOM 2	3.89M X 2.90M	12'9" X 9'6"
BEDROOM 3	3.89M X 2.17M	12'9" X 7'1"
TOTAL AREA	96.3 SQ M	1,036 SQ FT

APARTMENT N2.2

KITCHEN/LIVING/DINING	6.86M X 3.90M	22'6" X 12'10"
BEDROOM	4.61M X 3.51M	15'1" X 11'6"
TOTAL AREA	51.3 SQ M	552 SQ FT

APARTMENT N2.3

KITCHEN/LIVING/DINING	8.04 X 10.56M	26'5" X 34'8"
BEDROOM 1	7.91M X 3.82M	25'11" X 12'6"
BEDROOM 2	5.26M X 3.05M	17'3" X 10'0"
BEDROOM 3	4.23M X 3.95M	13'11" X 13'0"
TOTAL AREA	132.7 SQ M	1,428 SQ FT

APARTMENT M1.2 (Dual Level Villa)

BEDROOM 1	5.31M X 2.75M	17'5" X 9'0"
BEDROOM 2	4.19M X 2.95M	13'9" X 9'8"
BEDROOM 3	4.19M X 2.00M	13'9" X 6'7"
TOTAL AREA	108.8 SQ M	1,171 SQ FT

APARTMENT M1.3 (Dual Level Villa)

BEDROOM 1	5.31M X 2.75M	17'5" X 9'0"
BEDROOM 2	4.19M X 2.95M	13'9" X 9'8"
BEDROOM 3	4.19M X 2.00M	13'9" X 6'7"
TOTAL AREA	112.4 SQ M	1,209 SQ FT

APARTMENT M2.1

KITCHEN/LIVING/DINING	10.11M X 3.86M	33'2" X 12'8"
BEDROOM 1	4.63M X 3.15M	15'2" X 10'4"
BEDROOM 2	4.63M X 2.75M	15'2" X 9'0"
BEDROOM 3	4.26M X 2.07M	14'0" X 6'9"
TOTAL AREA	96.2 SQ M	1,035 SQ FT

APARTMENT M2.2

KITCHEN/LIVING/DINING	6.86M X 3.90M	22'6" X 12'10"
BEDROOM	4.61M X 3.51M	15'1" X 11'6"
TOTAL AREA	51.4 SQ M	553 SQ FT

APARTMENT M2.3

KITCHEN/LIVING/DINING	10.11M X 3.86M	33'2" X 12'8"
BEDROOM 1	4.63M X 3.15M	15'2" X 10'4"
BEDROOM 2	4.63M X 2.75M	15'2" X 9'0"
BEDROOM 3	4.26M X 2.07M	14'0" X 6'9"
TOTAL AREA	95.4 SQ M	1,026 SQ FT

APARTMENT L1.2 (Dual Level Villa)

BEDROOM 1	5.31M X 2.75M	17'5" X 9'0"
BEDROOM 2	4.19M X 2.95M	13'9" X 9'8"
BEDROOM 3	4.19M X 2.00M	13'9" X 6'7"
TOTAL AREA	108.9 SQ M	1,172 SQ FT

APARTMENT L1.3 (Dual Level Villa)

BEDROOM 1	5.31M X 2.75M	17'5" X 9'0"
BEDROOM 2	4.19M X 2.95M	13'9" X 9'8"
BEDROOM 3	4.19M X 2.00M	13'9" X 6'7"
TOTAL AREA	105.7 SQ M	1,137 SQ FT

APARTMENT L2.1

KITCHEN/LIVING/DINING	7.71M X 5.31M	25'4" X 17'5"
BEDROOM 1	5.02M X 4.03M	16'6" X 13'3"
BEDROOM 2	4.08M X 3.71M	13'5" X 12'2"
BEDROOM 3	3.89M X 2.75M	12'9" X 9'0"
TOTAL AREA	115.6 SQ M	1,244 SQ FT

APARTMENT L2.2

KITCHEN/LIVING/DINING	6.86M X 3.90M	22'6" X 12'10"
BEDROOM	4.61M X 3.51M	15'1" X 11'6"
TOTAL AREA	51.5 SQ M	554 SQ FT

APARTMENT L2.3

KITCHEN/LIVING/DINING	10.11M X 3.86M	33'2" X 12'8"
BEDROOM 1	4.59M X 2.91M	15'1" X 9'7"
BEDROOM 2	3.89M X 2.90M	12'9" X 9'6"
BEDROOM 3	3.89M X 2.17M	12'9" X 7'1"
TOTAL AREA	95.4 SQ M	1,026 SQ FT

PLOT LOCATION



■ Avenir House ■ Giles House ■ Hawthorn House

Arrows denote where measurements have been taken from.

We operate a policy of continuous improvement and individual features such as kitchen and bathroom layouts, doors, windows and elevational treatments may vary from time to time. Consequently these particulars should be treated as general guidance only and do not constitute a contract, part of a contract or a warranty. External finishes, landscaping and configuration may vary. Please refer to Sales Advisor for further details. All dimensions are approximate and should not be used for carpet sizes, appliance spaces or furniture. Furniture not to scale and all positions are indicative.

S denotes Services. B/S denotes Bin Store. C/S denotes Cycle Store.



THIRD FLOOR

AVENIR HOUSE (CORE N) / GILES HOUSE (CORE M) / HAWTHORN HOUSE (CORE L)

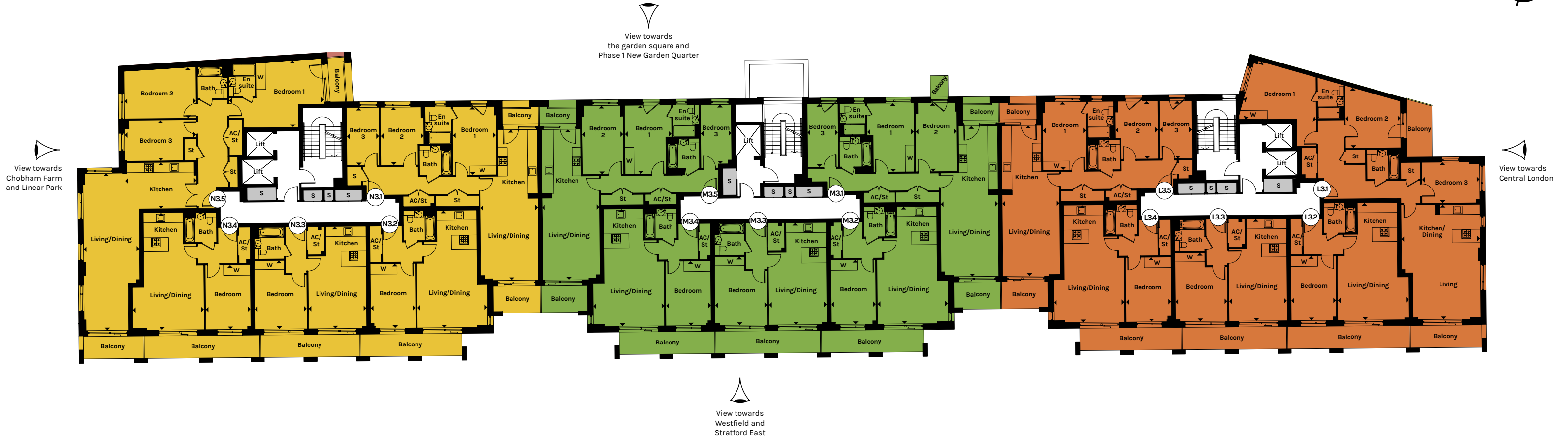

APARTMENT N3.1

KITCHEN/LIVING/DINING	10.11M X 3.86M	33'2" X 12'8"
BEDROOM 1	4.59 M X 2.91M	15'1" X 9'7"
BEDROOM 2	3.89M X 2.89M	12'9" X 9'6"
BEDROOM 3	3.89M X 2.16M	12'9" X 7'1"
TOTAL AREA	96.3 SQ M	1,036 SQ FT

APARTMENT N3.2

KITCHEN/LIVING/DINING	7.89M X 4.65M	25'11" X 15'3"
BEDROOM	4.34M X 3.03M	14'3" X 9'11"
TOTAL AREA	55.8 SQ M	601 SQ FT

APARTMENT N3.3

KITCHEN/LIVING/DINING	6.86M X 3.90M	22'6" X 12'10"
BEDROOM	4.61M X 3.51M	15'1" X 11'6"
TOTAL AREA	51.5 SQ M	554 SQ FT

APARTMENT N3.4

KITCHEN/LIVING/DINING	7.89M X 4.65M	25'11" X 15'3"
BEDROOM	4.34M X 3.03M	14'3" X 9'11"
TOTAL AREA	55.8 SQ M	601 SQ FT

APARTMENT N3.5

KITCHEN	4.83M X 3.11M	15'10" X 10'2"
LIVING/DINING	10.56M X 3.76M	34'8" X 12'2"
BEDROOM 1	6.37M X 4.46M	20'11" X 14'8"
BEDROOM 2	4.83M X 3.44M	15'10" X 11'3"
BEDROOM 3	4.83M X 2.75M	15'10" X 9'0"
TOTAL AREA	127.9 SQ M	1,376 SQ FT

APARTMENT M3.1

KITCHEN/LIVING/DINING	10.11M X 3.86M	33'2" X 12'8"
BEDROOM 1	4.62M X 3.15M	15'2" X 10'4"
BEDROOM 2	4.62M X 2.75M	15'2" X 9'0"
BEDROOM 3	4.26M X 2.07M	13'12" X 6'9"
TOTAL AREA	96.2 SQ M	1,035 SQ FT

APARTMENT M3.2

KITCHEN/LIVING/DINING	7.85M X 4.65M	25'9" X 15'3"
BEDROOM	4.34M X 3.03M	14'3" X 9'11"
TOTAL AREA	55.8 SQ M	601 SQ FT

APARTMENT M3.3

KITCHEN/LIVING/DINING	6.86M X 3.90M	22'6" X 12'10"
BEDROOM	4.61M X 3.51M	15'1" X 11'6"
TOTAL AREA	51.5 SQ M	554 SQ FT

APARTMENT M3.4

KITCHEN/LIVING/DINING	7.89M X 4.65M	25'11" X 15'3"
BEDROOM	4.34M X 3.03M	14'3" X 9'11"
TOTAL AREA	55.8 SQ M	600 SQ FT

APARTMENT M3.5

KITCHEN/LIVING/DINING	10.11M X 3.86M	33'2" X 12'8"
BEDROOM 1	4.62M X 3.15M	15'2" X 10'4"
BEDROOM 2	4.62M X 2.75M	15'2" X 9'0"
BEDROOM 3	4.26M X 2.07M	13'12" X 6'9"
TOTAL AREA	95.3 SQ M	1,025 SQ FT

APARTMENT L3.1

KITCHEN/LIVING/DINING	7.71M X 5.31M	25'4" X 17'5"
BEDROOM 1	5.02M X 4.03M	16'6" X 13'3"
BEDROOM 2	4.08M X 3.71M	13'5" X 12'2"
BEDROOM 3	3.89M X 2.75M	12'9" X 9'0"
TOTAL AREA	115.1 SQ M	1,238 SQ FT

APARTMENT L3.2

KITCHEN/LIVING/DINING	7.89M X 4.65M	25'11" X 15'3"
BEDROOM	4.34M X 3.03M	14'3" X 9'11"
TOTAL AREA	55.9 SQ M	602 SQ FT

APARTMENT L3.3

KITCHEN/LIVING/DINING	6.86M X 3.90M	22'6" X 12'10"
BEDROOM	4.61M X 3.51M	15'1" X 11'6"
TOTAL AREA	51.5 SQ M	554 SQ FT

APARTMENT L3.4

KITCHEN/LIVING/DINING	7.89M X 4.65M	25'11" X 15'3"
BEDROOM	4.34M X 3.03M	14'3" X 9'11"
TOTAL AREA	55.8 SQ M	601 SQ FT

APARTMENT L3.5

KITCHEN/LIVING/DINING	10.11M X 3.86M	33'2" X 12'8"
BEDROOM 1	4.59M X 2.91M	15'1" X 9'7"
BEDROOM 2	3.89M X 2.90M	12'9" X 9'6"
BEDROOM 3	3.89M X 2.17M	12'9" X 7'1"
TOTAL AREA	96.3 SQ M	1,037 SQ FT

PLOT LOCATION

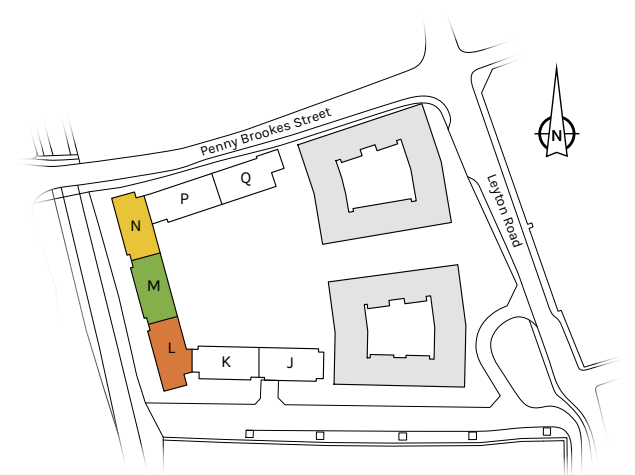

■ Avenir House
 ■ Giles House
 ■ Hawthorn House

S denotes Services. B/S denotes Bin Store. C/S denotes Cycle Store.

Arrows denote where measurements have been taken from.

We operate a policy of continuous improvement and individual features such as kitchen and bathroom layouts, doors, windows and elevational treatments may vary from time to time. Consequently these particulars should be treated as general guidance only and do not constitute a contract, part of a contract or a warranty. External finishes, landscaping and configuration may vary. Please refer to Sales Advisor for further details. All dimensions are approximate and should not be used for carpet sizes, appliance spaces or furniture. Furniture not to scale and all positions are indicative.



FOURTH FLOOR

AVENIR HOUSE (CORE N) / GILES HOUSE (CORE M) / HAWTHORN HOUSE (CORE L)

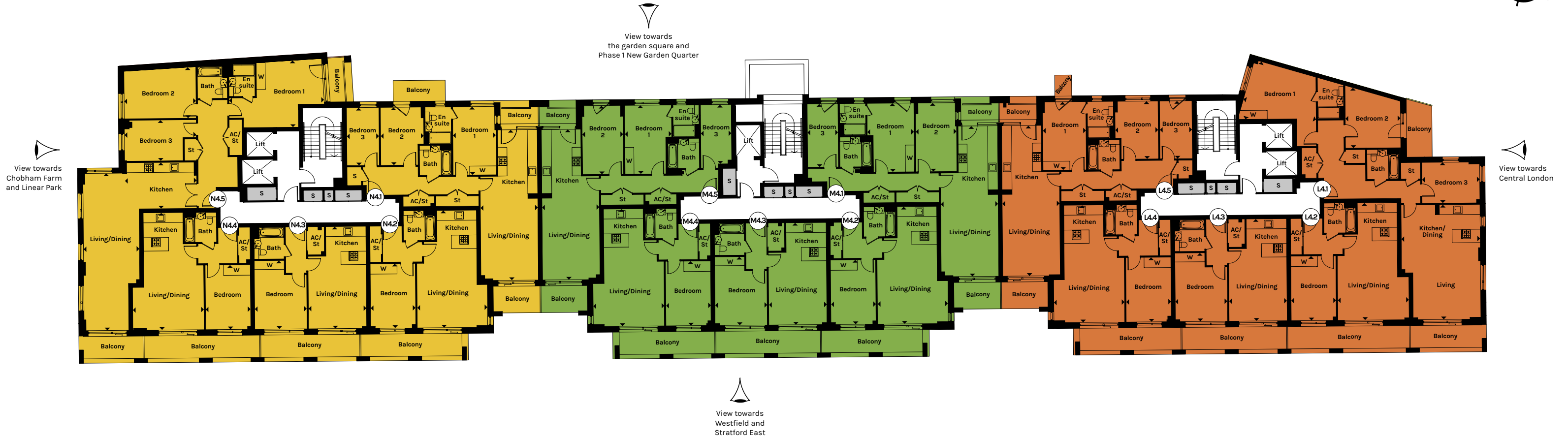

APARTMENT N4.1

KITCHEN/LIVING/DINING	10.11M X 3.86M	33'2" X 12'8"
BEDROOM 1	4.59M X 2.91M	15'1" X 9'7"
BEDROOM 2	3.89M X 2.89M	12'9" X 9'6"
BEDROOM 3	3.87M X 2.16M	12'9" X 7'1"
TOTAL AREA	96.3 SQ M	1,036 SQ FT

APARTMENT N4.2

KITCHEN/LIVING/DINING	7.89M X 4.65M	25'11" X 15'3"
BEDROOM	4.34M X 3.03M	14'3" X 9'11"
TOTAL AREA	55.8 SQ M	601 SQ FT

APARTMENT N4.3

KITCHEN/LIVING/DINING	6.86M X 3.90M	22'6" X 12'10"
BEDROOM	4.61M X 3.51M	15'2" X 11'6"
TOTAL AREA	51.5 SQ M	554 SQ FT

APARTMENT N4.4

KITCHEN/LIVING/DINING	7.89M X 4.65M	25'11" X 15'3"
BEDROOM	4.34M X 3.03M	14'3" X 9'11"
TOTAL AREA	55.8 SQ M	601 SQ FT

APARTMENT N4.5

KITCHEN	4.83M X 3.11M	15'10" X 10'2"
LIVING/DINING	10.56M X 3.76M	34'8" X 12'2"
BEDROOM 1	6.37M X 4.46M	20'11" X 14'8"
BEDROOM 2	4.83M X 3.44M	15'10" X 11'3"
BEDROOM 3	4.83M X 2.75M	15'10" X 9'0"
TOTAL AREA	127.9 SQ M	1,376 SQ FT

APARTMENT M4.1

KITCHEN/LIVING/DINING	10.11M X 3.86M	33'2" X 12'8"
BEDROOM 1	4.62M X 3.15M	15'2" X 10'4"
BEDROOM 2	4.62M X 2.75M	15'2" X 9'0"
BEDROOM 3	4.26M X 2.07M	13'12" X 6'9"
TOTAL AREA	96.2 SQ M	1,035 SQ FT

APARTMENT M4.2

KITCHEN/LIVING/DINING	7.85M X 4.62M	25'9" X 15'3"
BEDROOM	4.34M X 3.03M	14'3" X 9'11"
TOTAL AREA	55.8 SQ M	601 SQ FT

APARTMENT M4.3

KITCHEN/LIVING/DINING	6.86M X 3.90M	22'6" X 12'10"
BEDROOM	4.61M X 3.51M	15'1" X 11'6"
TOTAL AREA	51.5 SQ M	554 SQ FT

APARTMENT M4.4

KITCHEN/LIVING/DINING	7.89M X 4.65M	25'11" X 15'3"
BEDROOM	4.34M X 3.03M	14'3" X 9'11"
TOTAL AREA	55.8 SQ M	600 SQ FT

APARTMENT M4.5

KITCHEN/LIVING/DINING	10.11M X 3.86M	33'2" X 12'8"
BEDROOM 1	4.62M X 3.15M	15'2" X 10'4"
BEDROOM 2	4.62M X 2.75M	15'2" X 9'0"
BEDROOM 3	4.26M X 2.07M	13'12" X 6'9"
TOTAL AREA	95.3 SQ M	1,025 SQ FT

APARTMENT L4.1

KITCHEN/LIVING/DINING	5.02M X 4.03M	16'6" X 13'3"
BEDROOM 1	5.02M X 4.03M	16'6" X 13'3"
BEDROOM 2	4.08M X 3.71M	13'5" X 12'2"
BEDROOM 3	3.89M X 2.75M	12'9" X 9'0"
TOTAL AREA	115.1 SQ M	1,238 SQ FT

APARTMENT L4.2

KITCHEN/LIVING/DINING	7.89M X 4.65M	25'10" X 15'3"
BEDROOM	4.34M X 3.03M	14'3" X 9'11"
TOTAL AREA	55.8 SQ M	602 SQ FT

APARTMENT L4.3

KITCHEN/LIVING/DINING	6.86M X 3.90M	22'6" X 12'10"
BEDROOM	4.61M X 3.51M	15'1" X 11'6"
TOTAL AREA	51.5 SQ M	554 SQ FT

APARTMENT L4.4

KITCHEN/LIVING/DINING	7.89M X 4.65M	25'11" X 15'3"
BEDROOM	4.34M X 3.03M	14'3" X 9'11"
TOTAL AREA	55.8 SQ M	601 SQ FT

APARTMENT L4.5

KITCHEN/LIVING/DINING	10.11M X 3.86M	33'2" X 12'8"
BEDROOM 1	4.59M X 2.91M	15'1" X 9'7"
BEDROOM 2	3.89M X 2.90M	12'9" X 9'6"
BEDROOM 3	3.89M X 2.17M	12'9" X 7'1"
TOTAL AREA	96.3 SQ M	1,037 SQ FT

PLOT LOCATION

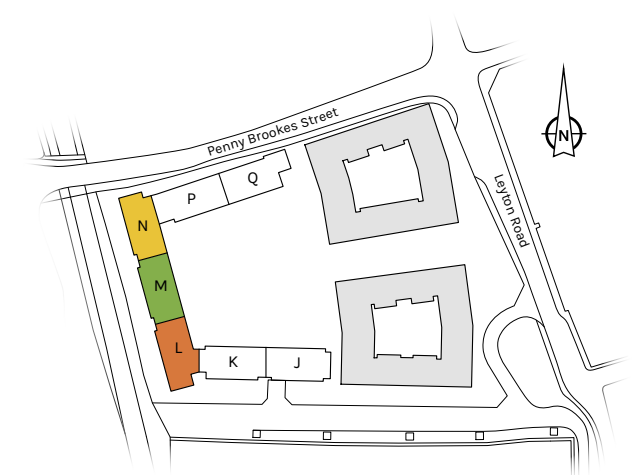

■ Avenir House ■ Giles House ■ Hawthorn House

Arrows denote where measurements have been taken from.

We operate a policy of continuous improvement and individual features such as kitchen and bathroom layouts, doors, windows and elevational treatments may vary from time to time. Consequently these particulars should be treated as general guidance only and do not constitute a contract, part of a contract or a warranty. External finishes, landscaping and configuration may vary. Please refer to Sales Advisor for further details. All dimensions are approximate and should not be used for carpet sizes, appliance spaces or furniture. Furniture not to scale and all positions are indicative.

S denotes Services. B/S denotes Bin Store. C/S denotes Cycle Store.



FIFTH FLOOR

AVENIR HOUSE (CORE N) / GILES HOUSE (CORE M) / HAWTHORN HOUSE (CORE L)

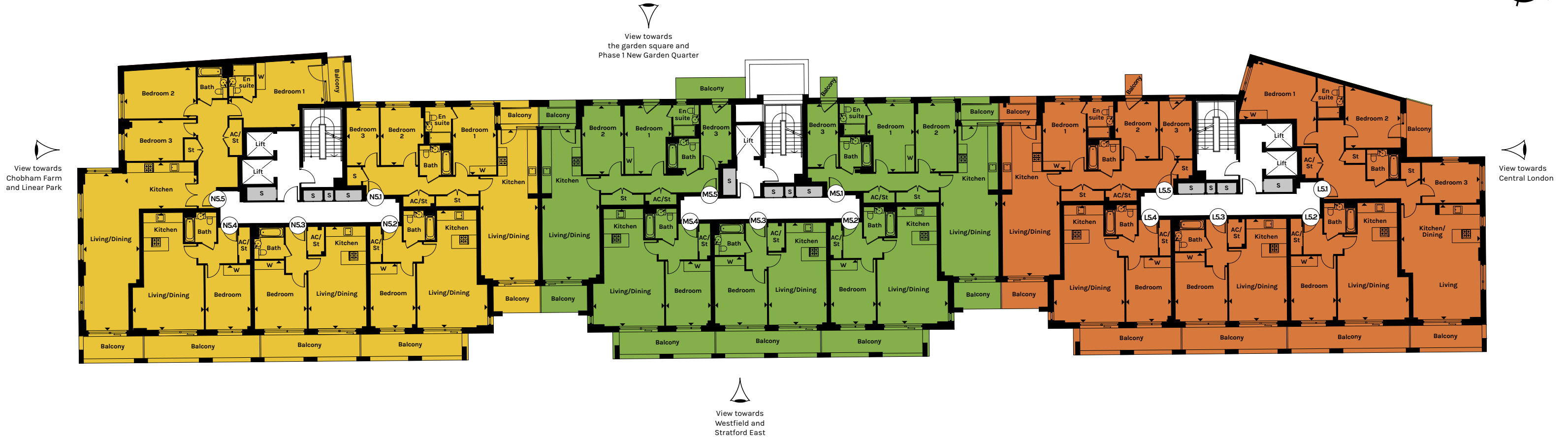

APARTMENT N5.1

KITCHEN/LIVING/DINING	10.11M X 3.86M	33'2" X 12'8"
BEDROOM 1	4.59M X 2.91M	15'1" X 9'7"
BEDROOM 2	3.89M X 2.89M	12'9" X 9'6"
BEDROOM 3	3.89M X 2.16M	12'9" X 7'1"
TOTAL AREA	96.3 SQ M	1,036 SQ FT

APARTMENT N5.2

KITCHEN/LIVING/DINING	7.89M X 4.65M	25'11" X 15'3"
BEDROOM	4.34M X 3.03M	14'3" X 9'11"
TOTAL AREA	55.8 SQ M	601 SQ FT

APARTMENT N5.3

KITCHEN/LIVING/DINING	6.86M X 3.90M	22'6" X 12'10"
BEDROOM	4.61M X 3.51M	15'2" X 11'6"
TOTAL AREA	51.5 SQ M	554 SQ FT

APARTMENT N5.4

KITCHEN/LIVING/DINING	7.89M X 4.65M	25'11" X 15'3"
BEDROOM	4.34M X 3.03M	14'3" X 9'11"
TOTAL AREA	55.9 SQ M	601 SQ FT

APARTMENT N5.5

KITCHEN	4.83M X 3.11M	15'10" X 10'2"
LIVING/DINING	10.56M X 3.76M	34'8" X 12'2"
BEDROOM 1	6.37M X 4.46M	20'11" X 14'8"
BEDROOM 2	4.83M X 3.44M	15'10" X 11'3"
BEDROOM 3	4.83M X 2.75M	15'10" X 9'0"
TOTAL AREA	127.9 SQ M	1,376 SQ FT

APARTMENT M5.1

KITCHEN/LIVING/DINING	10.11M X 3.86M	33'2" X 12'8"
BEDROOM 1	4.62M X 3.15M	15'2" X 10'4"
BEDROOM 2	4.62M X 2.75M	15'2" X 9'0"
BEDROOM 3	4.26M X 2.07M	13'12" X 6'9"
TOTAL AREA	96.2 SQ M	1,035 SQ FT

APARTMENT M5.2

KITCHEN/LIVING/DINING	7.85M X 4.65M	25'9" X 15'3"
BEDROOM	4.34M X 3.03M	14'3" X 9'11"
TOTAL AREA	55.8 SQ M	601 SQ FT

APARTMENT M5.3

KITCHEN/LIVING/DINING	6.86M X 3.90M	22'6" X 12'10"
BEDROOM	4.61M X 3.51M	15'1" X 11'6"
TOTAL AREA	51.5 SQ M	554 SQ FT

APARTMENT M5.4

KITCHEN/LIVING/DINING	7.89M X 4.65M	25'11" X 15'3"
BEDROOM	4.34M X 3.03M	14'3" X 9'11"
TOTAL AREA	55.8 SQ M	600 SQ FT

APARTMENT M5.5

KITCHEN/LIVING/DINING	10.11M X 3.86M	33'2" X 12'8"
BEDROOM 1	4.62M X 3.15M	15'2" X 10'4"
BEDROOM 2	4.62M X 2.75M	15'2" X 9'0"
BEDROOM 3	4.26M X 2.07M	13'12" X 6'9"
TOTAL AREA	95.3 SQ M	1,025 SQ FT

APARTMENT L5.1

KITCHEN/LIVING/DINING	7.71M X 5.31M	25'4" X 17'5"
BEDROOM 1	5.02M X 4.03M	16'6" X 13'3"
BEDROOM 2	4.08M X 3.71M	13'5" X 12'2"
BEDROOM 3	3.89M X 2.75M	12'9" X 9'0"
TOTAL AREA	115.1 SQ M	1,238 SQ FT

APARTMENT L5.2

KITCHEN/LIVING/DINING	7.89M X 4.65M	25'11" X 15'3"
BEDROOM	4.34M X 3.03M	14'3" X 9'11"
TOTAL AREA	55.9 SQ M	602 SQ FT

APARTMENT L5.3

KITCHEN/LIVING/DINING	6.86M X 3.90M	22'6" X 12'10"
BEDROOM	4.61M X 3.51M	15'1" X 11'6"
TOTAL AREA	51.5 SQ M	554 SQ FT

APARTMENT L5.4

KITCHEN/LIVING/DINING	7.89M X 4.65M	25'11" X 15'3"
BEDROOM	4.34M X 3.03M	14'3" X 9'11"
TOTAL AREA	55.8 SQ M	601 SQ FT

APARTMENT L5.5

KITCHEN/LIVING/DINING	10.11M X 3.86M	33'2" X 12'8"
BEDROOM 1	4.59M X 2.91M	15'1" X 9'7"
BEDROOM 2	3.89M X 2.90M	12'9" X 9'6"
BEDROOM 3	3.89M X 2.17M	12'9" X 7'1"
TOTAL AREA	96.3 SQ M	1,037 SQ FT

PLOT LOCATION



■ Avenir House
 ■ Giles House
 ■ Hawthorn House

S denotes Services. B/S denotes Bin Store. C/S denotes Cycle Store.

Arrows denote where measurements have been taken from.

We operate a policy of continuous improvement and individual features such as kitchen and bathroom layouts, doors, windows and elevational treatments may vary from time to time. Consequently these particulars should be treated as general guidance only and do not constitute a contract, part of a contract or a warranty. External finishes, landscaping and configuration may vary. Please refer to Sales Advisor for further details. All dimensions are approximate and should not be used for carpet sizes, appliance spaces or furniture. Furniture not to scale and all positions are indicative.



SIXTH FLOOR

AVENIR HOUSE (CORE N) / GILES HOUSE (CORE M) / HAWTHORN HOUSE (CORE L)

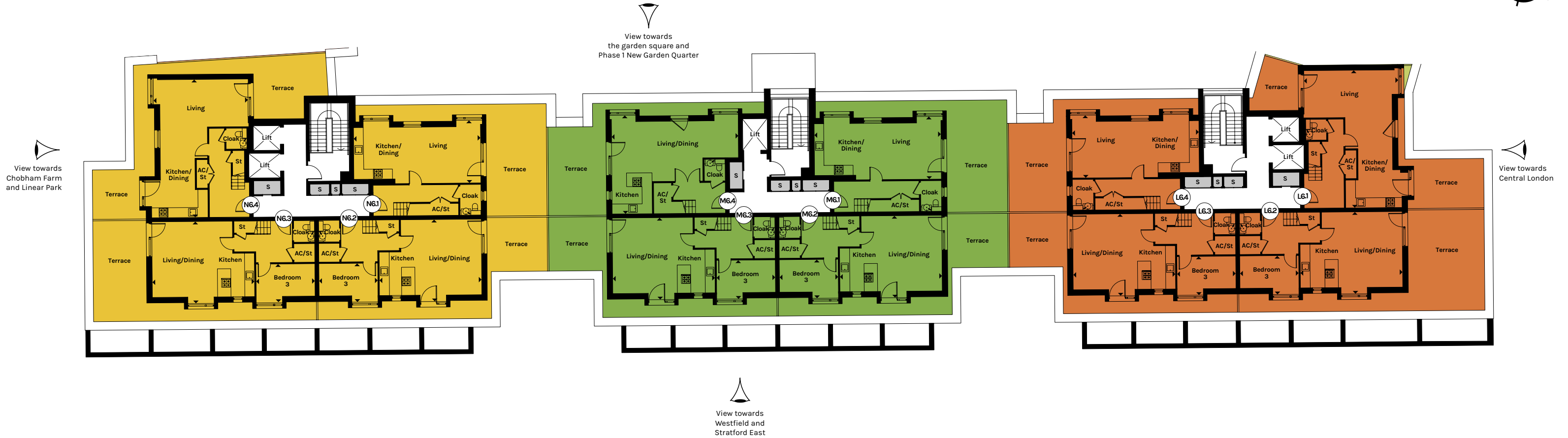

APARTMENT N6.1 (Dual Level Sky Villa)

KITCHEN/LIVING/DINING	8.53M X 4.21M	27'11" X 13'10"
TERRACE AREA	41.1 SQ M	442 SQ FT

APARTMENT N6.2 (Dual Level Sky Villa)

KITCHEN/LIVING/DINING	6.90M X 5.50M	22'8" X 18'1"
BEDROOM 3	3.93M X 2.61M	12'11" X 8'6"
TERRACE AREA	27.7 SQ M	298 SQ FT

APARTMENT N6.3 (Dual Level Sky Villa)

KITCHEN/LIVING/DINING	6.90M X 5.50M	22'8" X 18'1"
BEDROOM 3	3.93M X 2.61M	12'11" X 8'6"
TERRACE AREA	45.2 SQ M	487 SQ FT

APARTMENT N6.4 (Dual Level Sky Villa)

KITCHEN/LIVING/DINING	9.24M X 6.35M	30'4" X 20'10"
TERRACE AREA	45.5 SQ M	490 SQ FT

APARTMENT M6.1 (Dual Level Sky Villa)

KITCHEN/LIVING/DINING	8.51M X 4.21M	27'11" X 13'10"
TERRACE AREA	41.0 SQ M	441 SQ FT

APARTMENT M6.2 (Dual Level Sky Villa)

KITCHEN/LIVING/DINING	6.90M X 5.50M	22'8" X 18'1"
BEDROOM 3	3.93M X 2.61M	12'11" X 8'6"
TERRACE AREA	27.8 SQ M	299 SQ FT

APARTMENT M6.3 (Dual Level Sky Villa)

KITCHEN/LIVING/DINING	6.90M X 5.50M	22'8" X 18'1"
BEDROOM 3	3.93M X 2.61M	12'11" X 8'6"
TERRACE AREA	26.9 SQ M	290 SQ FT

APARTMENT M6.4 (Dual Level Sky Villa)

KITCHEN/LIVING/DINING	8.53M X 6.62M	27'11" X 22'9"
TERRACE AREA	34.0 SQ M	366 SQ FT

APARTMENT L6.1 (Dual Level Sky Villa)

KITCHEN/LIVING/DINING	9.25M X 6.35M	30'4" X 20'10"
TERRACE AREA	28.8 SQ M	310 SQ FT

APARTMENT L6.2 (Dual Level Sky Villa)

KITCHEN/LIVING/DINING	6.90M X 5.50M	22'8" X 18'1"
BEDROOM 3	3.93M X 2.61M	12'11" X 8'6"
TERRACE AREA	46.8 SQ M	504 SQ FT

APARTMENT L6.3 (Dual Level Sky Villa)

KITCHEN/LIVING/DINING	6.90M X 5.07M	22'8" X 16'8"
BEDROOM 3	3.93M X 2.61M	12'11" X 8'6"
TERRACE AREA	26.9 SQ M	290 SQ FT

APARTMENT L6.4 (Dual Level Sky Villa)

KITCHEN/LIVING/DINING	8.53M X 4.21M	28'0" X 13'10"
TERRACE AREA	34.4 SQ M	370 SQ FT

Arrows denote where measurements have been taken from.

We operate a policy of continuous improvement and individual features such as kitchen and bathroom layouts, doors, windows and elevational treatments may vary from time to time. Consequently these particulars should be treated as general guidance only and do not constitute a contract, part of a contract or a warranty. External finishes, landscaping and configuration may vary. Please refer to Sales Advisor for further details. All dimensions are approximate and should not be used for carpet sizes, appliance spaces or furniture. Furniture not to scale and all positions are indicative.

PLOT LOCATION



■ Avenir House ■ Giles House ■ Hawthorn House

S denotes Services. B/S denotes Bin Store. C/S denotes Cycle Store.



SEVENTH FLOOR

AVENIR HOUSE (CORE N) / GILES HOUSE (CORE M) / HAWTHORN HOUSE (CORE L)



APARTMENT N6.1 (Dual Level Sky Villa)

BEDROOM 1	4.12M X 2.89M	13'6" X 9'6"
BEDROOM 2	4.12M X 3.14M	13'6" X 10'4"
BEDROOM 3	3.87M X 2.38M	12'8" X 7'10"
TOTAL AREA	98.4 SQ M	1,059 SQ FT

APARTMENT N6.2 (Dual Level Sky Villa)

BEDROOM 1	5.21M X 3.25M	17'1" X 10'8"
BEDROOM 2	4.40M X 3.30M	14'5" X 10'10"
TOTAL AREA	98.1 SQ M	1,056 SQ FT

APARTMENT N6.3 (Dual Level Sky Villa)

BEDROOM 1	5.21M X 3.25M	17'1" X 10'8"
BEDROOM 2	4.40M X 3.30M	14'5" X 10'10"
TOTAL AREA	98.0 SQ M	1,055 SQ FT

APARTMENT N6.4 (Dual Level Sky Villa)

BEDROOM 1	4.10M X 2.90M	13'5" X 9'6"
BEDROOM 2	3.58M X 2.87M	11'9" X 9'5"
BEDROOM 3	4.45M X 3.27M	14'7" X 10'9"
TOTAL AREA	111.7 SQ M	1,202 SQ FT

APARTMENT M6.1 (Dual Level Sky Villa)

BEDROOM 1	4.11M X 2.89M	13'6" X 9'6"
BEDROOM 2	4.11M X 3.14M	13'6" X 10'4"
BEDROOM 3	3.87M X 2.33M	12'8" X 7'10"
TOTAL AREA	98.4 SQ M	1,059 SQ FT

APARTMENT M6.2 (Dual Level Sky Villa)

BEDROOM 1	5.21M X 3.25M	17'1" X 10'8"
BEDROOM 2	4.40M X 3.30M	14'5" X 10'10"
TOTAL AREA	98.0 SQ M	1,055 SQ FT

APARTMENT M6.3 (Dual Level Sky Villa)

BEDROOM 1	5.21M X 3.25M	17'1" X 10'8"
BEDROOM 2	4.40M X 3.30M	14'5" X 10'10"
TOTAL AREA	98.1 SQ M	1,056 SQ FT

APARTMENT M6.4 (Dual Level Sky Villa)

BEDROOM 1	4.37M X 3.30M	14'4" X 10'10"
BEDROOM 2	4.51M X 2.92M	14'10" X 9'8"
BEDROOM 3	3.15M X 1.97M	10'4" X 6'6"
TOTAL AREA	98.2 SQ M	1,057 SQ FT

APARTMENT L6.1 (Dual Level Sky Villa)

BEDROOM 1	4.10M X 2.90M	13'5" X 9'6"
BEDROOM 2	3.58M X 2.87M	11'0" X 9'5"
BEDROOM 3	4.44M X 3.27M	14'7" X 10'9"
TOTAL AREA	111.2 SQ M	1,197 SQ FT

APARTMENT L6.2 (Dual Level Sky Villa)

BEDROOM 1	5.21M X 3.25M	17'1" X 10'8"
BEDROOM 2	4.40M X 3.30M	14'5" X 10'10"
TOTAL AREA	98.1 SQ M	1,056 SQ FT

APARTMENT L6.3 (Dual Level Sky Villa)

BEDROOM 1	5.21M X 3.25M	17'1" X 10'8"
BEDROOM 2	4.40M X 3.30M	14'5" X 10'10"
TOTAL AREA	98.1 SQ M	1,056 SQ FT

APARTMENT L6.4 (Dual Level Sky Villa)

BEDROOM 1	4.12M X 2.89M	13'6" X 9'6"
BEDROOM 2	4.12M X 3.14M	13'6" X 10'4"
BEDROOM 3	3.87M X 2.38M	12'8" X 7'10"
TOTAL AREA	98.4 SQ M	1,059 SQ FT

PLOT LOCATION

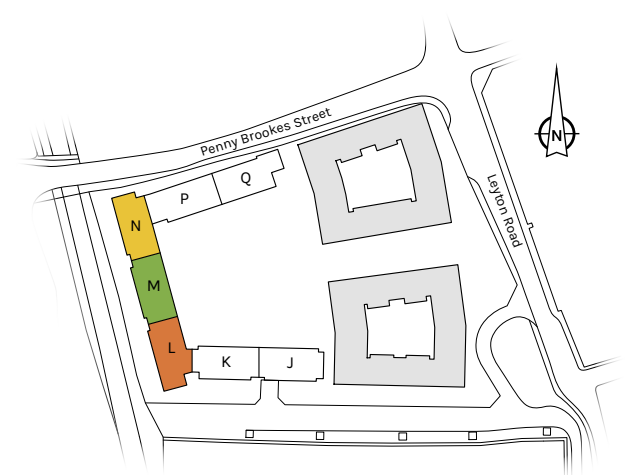

■ Avenir House
 ■ Giles House
 ■ Hawthorn House

S denotes Services. B/S denotes Bin Store. C/S denotes Cycle Store.

Arrows denote where measurements have been taken from. --- Reduced Head Height.

We operate a policy of continuous improvement and individual features such as kitchen and bathroom layouts, doors, windows and elevational treatments may vary from time to time. Consequently these particulars should be treated as general guidance only and do not constitute a contract, part of a contract or a warranty. External finishes, landscaping and configuration may vary. Please refer to Sales Advisor for further details. All dimensions are approximate and should not be used for carpet sizes, appliance spaces or furniture. Furniture not to scale and all positions are indicative.



GROUND FLOOR

LANGHAM HOUSE (CORE K) / BRAITHWAITE HOUSE (CORE J)

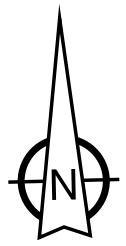

APARTMENT KO.1 (Dual Level Villa)

KITCHEN/DINING	5.01M X 2.85M	16'5" X 9'4"
BEDROOM 1	6.46M X 2.94M	21'3" X 9'8"
BEDROOM 2	4.37M X 2.80M	14'4" X 9'2"
BEDROOM 3	4.37M X 2.16M	14'4" X 7'1"
TERRACE LOWER	18.7 SQ M	202 SQ FT

APARTMENT KO.2 (Dual Level Villa)

KITCHEN/DINING	5.25M X 2.85M	17'3" X 9'4"
BEDROOM 1	6.46M X 2.75M	21'3" X 9'0"
BEDROOM 2	4.22M X 2.07M	13'10" X 6'9"
BEDROOM 3	4.22M X 2.07M	13'10" X 6'9"
TERRACE LOWER	16.8 SQ M	181 SQ FT

APARTMENT JO.2 (Dual Level Villa)

KITCHEN/DINING	5.20M X 2.85M	17'1" X 9'4"
BEDROOM 1	6.46M X 2.94M	21'2" X 9'8"
BEDROOM 2	4.36M X 2.80M	14'4" X 9'2"
BEDROOM 3	4.36M X 2.16M	14'4" X 7'1"
TERRACE LOWER	17.9 SQ M	193 SQ FT

Arrows denote where measurements have been taken from.

We operate a policy of continuous improvement and individual features such as kitchen and bathroom layouts, doors, windows and elevational treatments may vary from time to time. Consequently these particulars should be treated as general guidance only and do not constitute a contract, part of a contract or a warranty. External finishes, landscaping and configuration may vary. Please refer to Sales Advisor for further details. All dimensions are approximate and should not be used for carpet sizes, appliance spaces or furniture. Furniture not to scale and all positions are indicative.

PLOT LOCATION

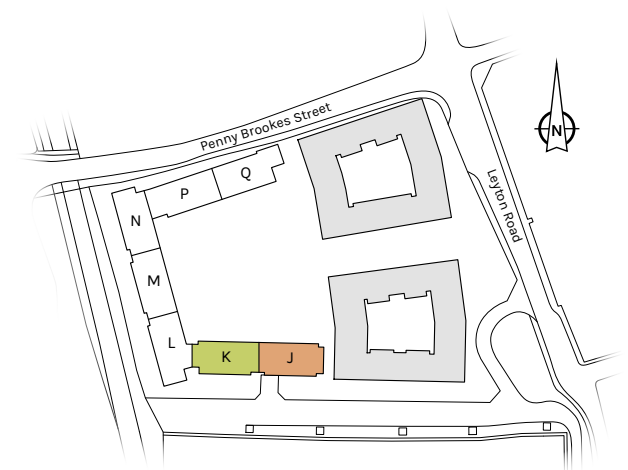

Langham House Braithwaite House Shared Ownership

S denotes Services. B/S denotes Bin Store. C/S denotes Cycle Store. M/S denotes Motorbike Spaces.



FIRST FLOOR

LANGHAM HOUSE (CORE K) / BRAITHWAITE HOUSE (CORE J)

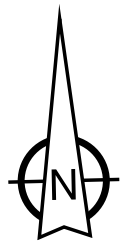

APARTMENT KO.1 (Dual Level Villa)

LIVING	5.86M X 3.62M	19'3" X 11'11"
TOTAL AREA	102.0 SQ M	1,098 SQ FT
TERRACE UPPER	39.5 SQ M	425 SQ FT

APARTMENT KO.2 (Dual Level Villa)

LIVING	5.86M X 3.62M	19'3" X 11'11"
TOTAL AREA	106.3 SQ M	1,144 SQ FT
TERRACE UPPER	41.3 SQ M	445 SQ FT

APARTMENT K1.1

KITCHEN/LIVING/DINING	10.11M X 3.86M	33'2" X 12'8"
BEDROOM 1	4.62M X 3.15M	15'2" X 10'4"
BEDROOM 2	4.62M X 2.85M	15'2" X 9'4"
BEDROOM 3	4.26M X 2.07M	13'12" X 6'9"
TOTAL AREA	96.3 SQ M	1,036 SQ FT
TERRACE AREA	62.5 SQ M	672 SQ FT

APARTMENT K1.2 (Dual Level Villa)

KITCHEN/LIVING/DINING	7.77M X 4.96M	25'6" X 16'3"
TERRACE AREA	67.3 SQ M	724 SQ FT

APARTMENT K1.3 (Dual Level Villa)

KITCHEN/LIVING/DINING	7.77M X 4.96M	25'6" X 16'3"
TOTAL AREA	108.9 SQ M	1,172 SQ FT
TERRACE AREA	67.7 SQ M	728 SQ FT

APARTMENT K1.4

KITCHEN/LIVING/DINING	10.11M X 3.86M	33'2" X 8'9"
BEDROOM 1	4.62M X 3.15M	15'2" X 9'0"
BEDROOM 2	4.62M X 2.95M	15'2" X 9'8"
BEDROOM 3	4.26M X 2.07M	13'12" X 6'9"
TOTAL AREA	95.4 SQ M	1,026 SQ FT
TERRACE AREA	61.8 SQ M	665 SQ FT

APARTMENT JO.2 (Dual Level Villa)

LIVING	5.86M X 3.62M	19'3" X 11'11"
TOTAL AREA	106.3 SQ M	1,144 SQ FT
TERRACE UPPER	40.8 SQ M	439 SQ FT

APARTMENT J1.2 (Dual Level Villa)

KITCHEN/LIVING/DINING	7.92M X 4.96M	26'0" X 16'3"
TERRACE AREA	65.0 SQ M	701 SQ FT

APARTMENT J1.3 (Dual Level Villa)

KITCHEN/LIVING/DINING	7.73M X 4.96M	25'4" X 16'3"
TERRACE AREA	64.8 SQ M	697 SQ FT

PLOT LOCATION

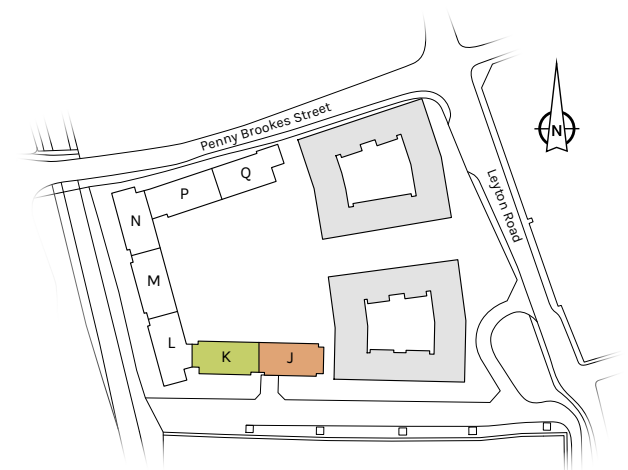

Arrows denote where measurements have been taken from.

We operate a policy of continuous improvement and individual features such as kitchen and bathroom layouts, doors, windows and elevational treatments may vary from time to time. Consequently these particulars should be treated as general guidance only and do not constitute a contract, part of a contract or a warranty. External finishes, landscaping and configuration may vary. Please refer to Sales Advisor for further details. All dimensions are approximate and should not be used for carpet sizes, appliance spaces or furniture. Furniture not to scale and all positions are indicative.

Langham House Braithwaite House Shared Ownership

S denotes Services. B/S denotes Bin Store. C/S denotes Cycle Store.



SECOND FLOOR

LANGHAM HOUSE (CORE K) / BRAITHWAITE HOUSE (CORE J)

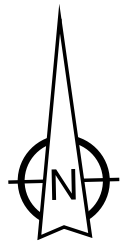

APARTMENT K1.2 (Dual Level Villa)

BEDROOM 1	5.31M X 2.75M	17'5" X 9'0"
BEDROOM 2	4.19M X 2.95M	13'9" X 9'8"
BEDROOM 3	4.19M X 2.00M	13'9" X 6'7"
TOTAL AREA	108.7 SQ M	1,170 SQ FT

APARTMENT K1.3 (Dual Level Villa)

BEDROOM 1	5.31M X 2.75M	17'5" X 9'0"
BEDROOM 2	4.19M X 2.97M	13'9" X 9'9"
BEDROOM 3	4.19M X 2.00M	13'9" X 6'7"
TOTAL AREA	108.9 SQ M	1,172 SQ FT

APARTMENT K2.1

KITCHEN/LIVING/DINING	10.11M X 3.86M	33'2" X 12'8"
BEDROOM 1	4.62M X 3.15M	15'2" X 10'4"
BEDROOM 2	4.62M X 2.75M	15'2" X 9'0"
BEDROOM 3	4.26M X 2.07M	14'0" X 6'9"
TOTAL AREA	96.2 SQ M	1,035 SQ FT

APARTMENT K2.2

KITCHEN/LIVING/DINING	9.10M X 3.90M	29'10" X 12'10"
BEDROOM	4.61M X 3.51M	15'2" X 10'4"
TOTAL AREA	51.6 SQ M	555 SQ FT

APARTMENT K2.3

KITCHEN/LIVING/DINING	10.11M X 3.86M	33'2" X 12'8"
BEDROOM 1	4.62M X 3.15M	15'2" X 10'4"
BEDROOM 2	4.62M X 2.75M	15'2" X 9'0"
BEDROOM 3	4.26M X 2.07M	14'0" X 6'9"
TOTAL AREA	95.4 SQ M	1,026 SQ FT

APARTMENT J1.2 (Dual Level Villa)

BEDROOM 1	5.31M X 2.75M	17'5" X 9'0"
BEDROOM 2	4.19M X 2.95M	13'9" X 9'8"
BEDROOM 3	4.19M X 2.00M	13'9" X 6'7"
TOTAL AREA	109.0 SQ M	1,173 SQ FT

APARTMENT J1.3 (Dual Level Villa)

BEDROOM 1	5.31M X 2.75M	17'5" X 9'0"
BEDROOM 2	4.19M X 2.92M	13'9" X 9'7"
BEDROOM 3	4.19M X 2.00M	13'9" X 6'7"
TOTAL AREA	120.8 SQ M	1,300 SQ FT

PLOT LOCATION

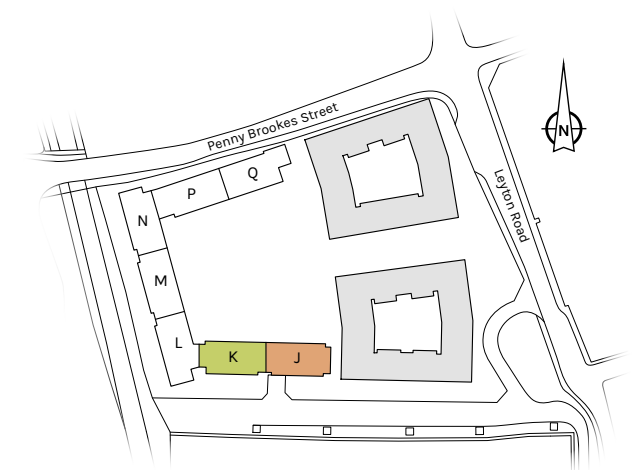

Arrows denote where measurements have been taken from.

We operate a policy of continuous improvement and individual features such as kitchen and bathroom layouts, doors, windows and elevational treatments may vary from time to time. Consequently these particulars should be treated as general guidance only and do not constitute a contract, part of a contract or a warranty. External finishes, landscaping and configuration may vary. Please refer to Sales Advisor for further details. All dimensions are approximate and should not be used for carpet sizes, appliance spaces or furniture. Furniture not to scale and all positions are indicative.

Langham House Braithwaite House Shared Ownership

S denotes Services. B/S denotes Bin Store. C/S denotes Cycle Store.



THIRD FLOOR

LANGHAM HOUSE (CORE K) / BRAITHWAITE HOUSE (CORE J)

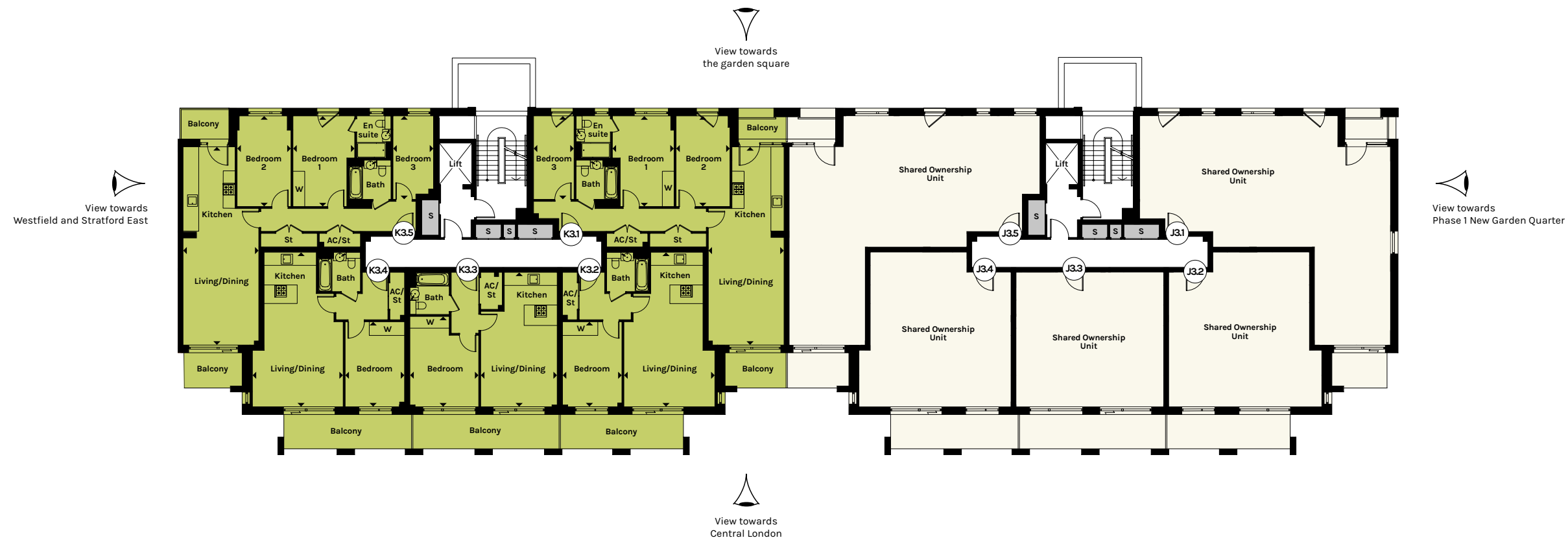
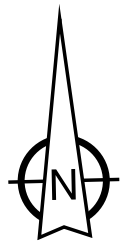

APARTMENT K3.1

KITCHEN/LIVING/DINING	10.11M X 3.86M	33'2" X 12'8"
BEDROOM 1	4.62M X 3.15M	15'2" X 10'4"
BEDROOM 2	4.62M X 2.75M	15'2" X 9'0"
BEDROOM 3	4.26M X 2.07M	13'12" X 6'9"
TOTAL AREA	96.3 SQ M	1,037 SQ FT

APARTMENT K3.2

KITCHEN/LIVING/DINING	7.89M X 4.64M	25'11" X 15'3"
BEDROOM	4.34M X 3.03M	14'3" X 9'11"
TOTAL AREA	55.9 SQ M	602 SQ FT

APARTMENT K3.3

KITCHEN/LIVING/DINING	6.86M X 3.90M	22'6" X 12'10"
BEDROOM	4.61M X 3.51M	15'1" X 11'6"
TOTAL AREA	51.5 SQ M	554 SQ FT

APARTMENT K3.4

KITCHEN/LIVING/DINING	7.89M X 4.63M	25'11" X 15'2"
BEDROOM	4.34M X 3.03M	14'3" X 9'11"
TOTAL AREA	55.9 SQ M	602 SQ FT

APARTMENT K3.5

KITCHEN/LIVING/DINING	10.11M X 3.86M	33'2" X 12'8"
BEDROOM 1	4.62M X 3.15M	15'2" X 10'4"
BEDROOM 2	4.62M X 2.75M	15'2" X 9'0"
BEDROOM 3	4.26M X 2.07M	13'12" X 6'9"
TOTAL AREA	96.5 SQ M	1,039 SQ FT

Arrows denote where measurements have been taken from.

We operate a policy of continuous improvement and individual features such as kitchen and bathroom layouts, doors, windows and elevational treatments may vary from time to time. Consequently these particulars should be treated as general guidance only and do not constitute a contract, part of a contract or a warranty. External finishes, landscaping and configuration may vary. Please refer to Sales Advisor for further details. All dimensions are approximate and should not be used for carpet sizes, appliance spaces or furniture. Furniture not to scale and all positions are indicative.

Langham House Braithwaite House Shared Ownership

S denotes Services. B/S denotes Bin Store. C/S denotes Cycle Store.

PLOT LOCATION

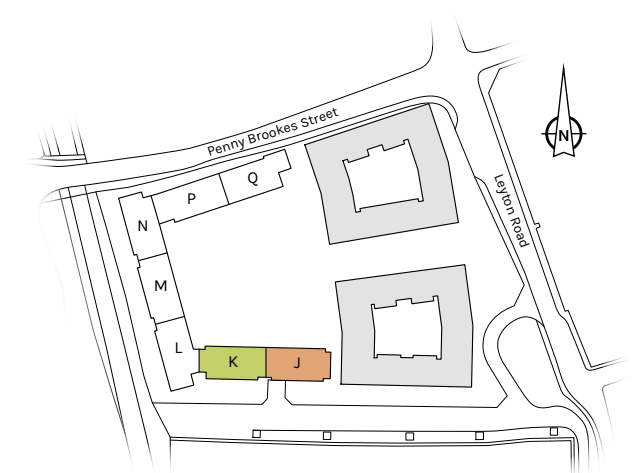



FOURTH FLOOR

LANGHAM HOUSE (CORE K) / BRAITHWAITE HOUSE (CORE J)

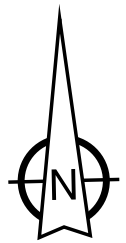

APARTMENT K4.1

KITCHEN/LIVING/DINING	10.11M X 3.86M	33'2" X 12'8"
BEDROOM 1	4.62M X 3.15M	15'2" X 10'4"
BEDROOM 2	4.62M X 2.75M	15'2" X 9'0"
BEDROOM 3	4.26M X 2.07M	13'12" X 6'9"
TOTAL AREA	96.3 SQ M	1,036 SQ FT

APARTMENT K4.2

KITCHEN/LIVING/DINING	7.89M X 4.64M	25'11" X 15'3"
BEDROOM	4.34M X 3.03M	14'3" X 9'11"
TOTAL AREA	55.9 SQ M	602 SQ FT

APARTMENT K4.3

KITCHEN/LIVING/DINING	6.86M X 3.90M	22'6" X 12'10"
BEDROOM	4.61M X 3.51M	15'1" X 11'6"
TOTAL AREA	51.5 SQ M	554 SQ FT

APARTMENT K4.4

KITCHEN/LIVING/DINING	7.89M X 4.63M	25'11" X 15'2"
BEDROOM	4.34M X 3.03M	14'3" X 9'11"
TOTAL AREA	55.9 SQ M	602 SQ FT

APARTMENT K4.5

KITCHEN/LIVING/DINING	10.11M X 3.86M	33'2" X 12'8"
BEDROOM 1	4.62M X 3.15M	15'2" X 10'4"
BEDROOM 2	4.62M X 2.75M	15'2" X 9'0"
BEDROOM 3	4.26M X 2.07M	13'12" X 6'9"
TOTAL AREA	96.5 SQ M	1,039 SQ FT

APARTMENT J4.1

KITCHEN/LIVING/DINING	10.11M X 3.86M	33'2" X 12'8"
BEDROOM 1	4.62M X 3.15M	15'2" X 10'4"
BEDROOM 2	4.62M X 2.75M	15'2" X 9'0"
BEDROOM 3	4.26M X 2.07M	13'12" X 6'9"
TOTAL AREA	96.4 SQ M	1,038 SQ FT

APARTMENT J4.2

KITCHEN/LIVING/DINING	7.89M X 4.65M	25'11" X 15'3"
BEDROOM	4.34M X 3.03M	14'3" X 9'11"
TOTAL AREA	55.9 SQ M	602 SQ FT

APARTMENT J4.4

KITCHEN/LIVING/DINING	7.89M X 4.63M	25'11" X 15'3"
BEDROOM	4.34M X 3.03M	14'3" X 9'11"
TOTAL AREA	55.9 SQ M	601 SQ FT

APARTMENT J4.5

KITCHEN/LIVING/DINING	10.11M X 3.86M	33'2" X 12'8"
BEDROOM 1	4.63M X 3.15M	15'2" X 10'4"
BEDROOM 2	4.63M X 2.75M	15'2" X 9'0"
BEDROOM 3	4.26M X 2.07M	13'12" X 6'9"
TOTAL AREA	96.7 SQ M	1,040 SQ FT

PLOT LOCATION

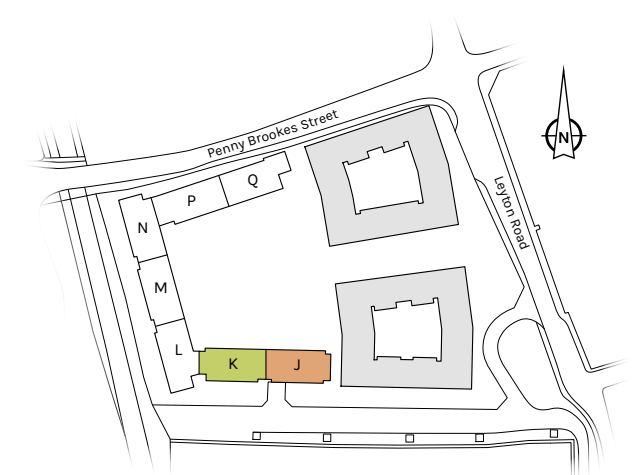

Arrows denote where measurements have been taken from.

We operate a policy of continuous improvement and individual features such as kitchen and bathroom layouts, doors, windows and elevational treatments may vary from time to time. Consequently these particulars should be treated as general guidance only and do not constitute a contract, part of a contract or a warranty. External finishes, landscaping and configuration may vary. Please refer to Sales Advisor for further details. All dimensions are approximate and should not be used for carpet sizes, appliance spaces or furniture. Furniture not to scale and all positions are indicative.

Langham House Braithwaite House Shared Ownership

S denotes Services. B/S denotes Bin Store. C/S denotes Cycle Store.



FIFTH FLOOR

LANGHAM HOUSE (CORE K) / BRAITHWAITE HOUSE (CORE J)

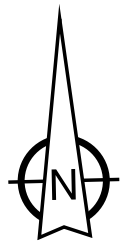

APARTMENT K5.1

KITCHEN/LIVING/DINING	10.11M X 3.86M	33'2" X 12'8"
BEDROOM 1	4.62M X 3.15M	15'2" X 10'4"
BEDROOM 2	4.62M X 2.75M	15'2" X 9'0"
BEDROOM 3	4.26M X 2.07M	13'12" X 6'9"
TOTAL AREA	96.3 SQ M	1,036 SQ FT

APARTMENT K5.2

KITCHEN/LIVING/DINING	7.89M X 4.65M	25'11" X 15'3"
BEDROOM	4.34M X 3.03M	14'3" X 9'11"
TOTAL AREA	55.9 SQ M	602 SQ FT

APARTMENT K5.3

KITCHEN/LIVING/DINING	6.86M X 3.90M	22'6" X 12'10"
BEDROOM	4.61M X 3.51M	15'1" X 11'6"
TOTAL AREA	51.5 SQ M	554 SQ FT

APARTMENT K5.4

KITCHEN/LIVING/DINING	7.89M X 4.65M	25'11" X 15'3"
BEDROOM	4.34M X 3.03M	14'3" X 9'11"
TOTAL AREA	55.9 SQ M	602 SQ FT

APARTMENT K5.5

KITCHEN/LIVING/DINING	10.11M X 3.86M	33'2" X 12'8"
BEDROOM 1	4.62M X 3.15M	15'2" X 10'4"
BEDROOM 2	4.62M X 2.75M	15'2" X 9'0"
BEDROOM 3	4.26M X 2.07M	13'12" X 6'9"
TOTAL AREA	96.5 SQ M	1,039 SQ FT

APARTMENT J5.1

KITCHEN/LIVING/DINING	10.11M X 3.86M	33'2" X 12'8"
BEDROOM 1	4.62M X 3.15M	15'2" X 10'4"
BEDROOM 2	4.62M X 2.75M	15'2" X 9'0"
BEDROOM 3	4.26M X 2.07M	13'12" X 6'9"
TOTAL AREA	96.4 SQ M	1,038 SQ FT

APARTMENT J5.2

KITCHEN/LIVING/DINING	7.89M X 4.64M	25'11" X 15'3"
BEDROOM	4.34M X 3.03M	14'3" X 9'11"
TOTAL AREA	55.9 SQ M	602 SQ FT

APARTMENT J5.3

KITCHEN/LIVING/DINING	6.86M X 3.90M	22'6" X 12'10"
BEDROOM	4.61M X 3.51M	15'1" X 11'6"
TOTAL AREA	51.5 SQ M	554 SQ FT

APARTMENT J5.4

KITCHEN/LIVING/DINING	7.89M X 4.65M	25'11" X 15'3"
BEDROOM	4.34M X 3.03M	14'3" X 9'11"
TOTAL AREA	55.9 SQ M	602 SQ FT

APARTMENT J5.5

KITCHEN/LIVING/DINING	10.11M X 3.86M	33'2" X 12'8"
BEDROOM 1	4.62M X 3.15M	15'2" X 10'4"
BEDROOM 2	4.62M X 2.75M	15'2" X 9'0"
BEDROOM 3	4.26M X 2.07M	13'12" X 6'9"
TOTAL AREA	96.6 SQ M	1,040 SQ FT

PLOT LOCATION

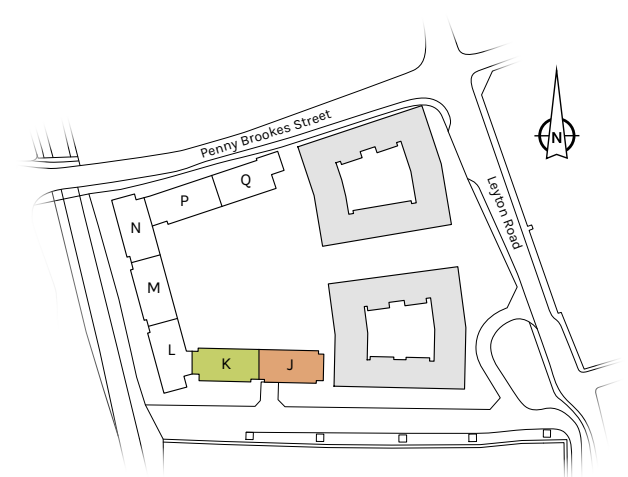

Arrows denote where measurements have been taken from.

We operate a policy of continuous improvement and individual features such as kitchen and bathroom layouts, doors, windows and elevational treatments may vary from time to time. Consequently these particulars should be treated as general guidance only and do not constitute a contract, part of a contract or a warranty. External finishes, landscaping and configuration may vary. Please refer to Sales Advisor for further details. All dimensions are approximate and should not be used for carpet sizes, appliance spaces or furniture. Furniture not to scale and all positions are indicative.

Langham House Braithwaite House

S denotes Services. B/S denotes Bin Store. C/S denotes Cycle Store.



SIXTH FLOOR

LANGHAM HOUSE (CORE K) / BRAITHWAITE HOUSE (CORE J)

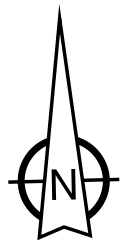

APARTMENT K6.1 (Dual Level Sky Villa)

KITCHEN/LIVING/DINING	8.52M X 4.20M	27'11" X 13'10"
TERRACE AREA	40.8 SQ M	439 SQ FT

APARTMENT K6.2 (Dual Level Sky Villa)

KITCHEN/LIVING/DINING	6.90M X 5.51M	22'8" X 18'1"
BEDROOM 3	3.93M X 2.61M	12'11" X 8'6"
TERRACE AREA	27.8 SQ M	299 SQ FT

APARTMENT K6.3 (Dual Level Sky Villa)

KITCHEN/LIVING/DINING	6.90M X 5.51M	22'8" X 18'1"
BEDROOM 3	3.93M X 2.61M	12'11" X 8'8"
TERRACE AREA	22.4 SQ M	241 SQ FT

APARTMENT K6.4 (Dual Level Sky Villa)

KITCHEN/LIVING/DINING	8.49M X 6.62M	27'10" X 21'9"
TERRACE AREA	34.2 SQ M	368 SQ FT

APARTMENT J6.1 (Dual Level Sky Villa)

KITCHEN/LIVING/DINING	8.52M X 4.20M	27'11" X 13'10"
TERRACE AREA	37.1 SQ M	399 SQ FT

APARTMENT J6.2 (Dual Level Sky Villa)

KITCHEN/LIVING/DINING	6.90M X 5.51M	22'8" X 18'1"
BEDROOM 3	3.93M X 2.61M	12'11" X 8'6"
TERRACE AREA	26.7 SQ M	287 SQ FT

APARTMENT J6.3 (Dual Level Sky Villa)

KITCHEN/LIVING/DINING	6.90M X 5.51M	22'8" X 18'1"
BEDROOM 3	3.93M X 2.61M	12'11" X 8'6"
TERRACE AREA	26.5 SQ M	285 SQ FT

APARTMENT J6.4 (Dual Level Sky Villa)

KITCHEN/LIVING/DINING	8.49M X 6.62M	27'10" X 21'9"
TERRACE AREA	33.4 SQ M	360 SQ FT

Arrows denote where measurements have been taken from.

We operate a policy of continuous improvement and individual features such as kitchen and bathroom layouts, doors, windows and elevational treatments may vary from time to time. Consequently these particulars should be treated as general guidance only and do not constitute a contract, part of a contract or a warranty. External finishes, landscaping and configuration may vary. Please refer to Sales Advisor for further details. All dimensions are approximate and should not be used for carpet sizes, appliance spaces or furniture. Furniture not to scale and all positions are indicative.

Langham House Braithwaite House

S denotes Services. B/S denotes Bin Store. C/S denotes Cycle Store.

PLOT LOCATION

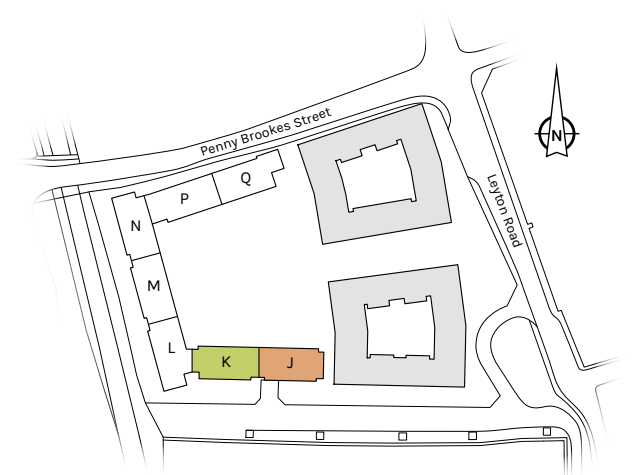



SEVENTH FLOOR

LANGHAM HOUSE (CORE K) / BRAITHWAITE HOUSE (CORE J)

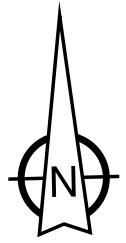

View towards
the garden square

View towards
Westfield and Stratford East

View towards
Phase 1 New Garden Quarter

View towards
Central London



APARTMENT K6.1 (Dual Level Sky Villa)

BEDROOM 1	4.11M X 2.87M	13'6" X 9'5"
BEDROOM 2	3.87M X 3.14M	12'8" X 10'4"
BEDROOM 3	4.11M X 2.38M	13'6" X 7'10"
TOTAL AREA	98.3 SQ M	1,058 SQ FT

APARTMENT K6.2 (Dual Level Sky Villa)

BEDROOM 1	5.21M X 3.25M	17'1" X 10'8"
BEDROOM 2	4.40M X 3.30M	14'5" X 10'10"
TOTAL AREA	98.0 SQ M	1,055 SQ FT

APARTMENT K6.3 (Dual Level Sky Villa)

BEDROOM 1	5.21M X 3.25M	17'1" X 10'8"
BEDROOM 2	4.40M X 3.30M	14'5" X 10'10"
TOTAL AREA	98.0 SQ M	1,055 SQ FT

APARTMENT K6.4 (Dual Level Sky Villa)

BEDROOM 1	4.37M X 3.30M	14'4" X 10'10"
BEDROOM 2	4.51M X 2.93M	14'10" X 9'7"
BEDROOM 3	3.14M X 1.97M	10'4" X 6'6"
TOTAL AREA	98.3 SQ M	1,058 SQ FT

APARTMENT J6.1 (Dual Level Sky Villa)

BEDROOM 1	4.11M X 2.87M	13'6" X 9'5"
BEDROOM 2	3.87M X 3.14M	12'8" X 10'4"
BEDROOM 3	4.11M X 2.38M	13'6" X 7'10"
TOTAL AREA	98.3 SQ M	1,058 SQ FT

APARTMENT J6.2 (Dual Level Sky Villa)

BEDROOM 1	5.21M X 3.25M	17'1" X 10'8"
BEDROOM 2	4.40M X 3.30M	14'5" X 10'10"
TOTAL AREA	98.0 SQ M	1,055 SQ FT

APARTMENT J6.3 (Dual Level Sky Villa)

BEDROOM 1	5.21M X 3.25M	17'1" X 10'8"
BEDROOM 2	4.40M X 3.30M	14'5" X 10'10"
TOTAL AREA	98.0 SQ M	1,055 SQ FT

APARTMENT J6.4 (Dual Level Sky Villa)

BEDROOM 1	4.37M X 3.30M	14'4" X 10'10"
BEDROOM 2	4.51M X 2.93M	14'10" X 9'7"
BEDROOM 3	3.14M X 1.97M	10'4" X 6'6"
TOTAL AREA	98.3 SQ M	1,058 SQ FT

PLOT LOCATION

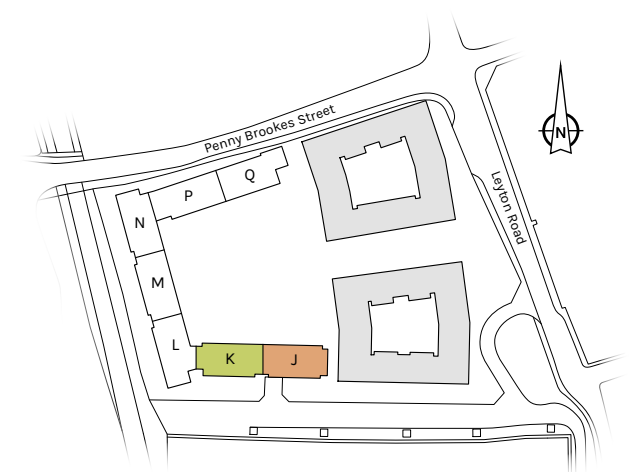

Langham House Braithwaite House

S denotes Services. B/S denotes Bin Store. C/S denotes Cycle Store.

Arrows denote where measurements have been taken from. --- Reduced Head Height.

We operate a policy of continuous improvement and individual features such as kitchen and bathroom layouts, doors, windows and elevational treatments may vary from time to time. Consequently these particulars should be treated as general guidance only and do not constitute a contract, part of a contract or a warranty. External finishes, landscaping and configuration may vary. Please refer to Sales Advisor for further details. All dimensions are approximate and should not be used for carpet sizes, appliance spaces or furniture. Furniture not to scale and all positions are indicative.



QUALITY AND ATTENTION TO DETAIL



GENERAL FEATURES

- 24 hour concierge service
- Residents' gymnasium
- Underfloor heating
- Bicycle storage
- Car parking available by separate negotiation

KITCHENS

- High-gloss white, handle-less fitted units from London designer Urban Myth
- Stone worktops
- Fully integrated Smeg appliances: stainless steel oven, ceramic hob, extractor hood, dishwasher, fridge/freezer, microwave & washer/dryer
- Glass splash-backs
- Feature lighting under wall units

BATH & ENSUITE SHOWER ROOMS

- Pure white bathroom suites with chrome taps and mixers
- Bath with thermostatic shower mixer and glazed screen (where applicable)
- Large shower enclosure to ensuite
- Contemporary porcelain & ceramic tiling
- Large vanity mirror
- Towel warmer
- Bespoke cabinetry with built in storage & low voltage socket

FLOORING

- Kitchen, living room & hallway in woodstrip laminate flooring
- Bedrooms carpeted in a soft grey colour tone

DÉCOR

- Smooth finish to all walls & ceilings, painted in white emulsion
- White satinwood finish to doors & woodwork

FIXTURES & FITTINGS

- Fitted wardrobe to main bedroom
- Satin silver chrome door handles
- Recessed downlights to kitchen, living room & bathrooms
- SkyQ, TV and telephone outlets to living room, with TV outlets to all bedrooms

SECURITY & WARRANTIES

- Video entryphone system to all apartments
- Monitored CCTV system
- 10 year 'NHBC' warranty
- Two year 24/7 emergency cover
- Comprehensive induction with dedicated Customer Service Manager

99%
OF OUR CUSTOMERS
RECOMMEND US

The Telford Homes brand delivers high quality, highly desirable new homes that are supported by first-class customer service.

The Telford Homes brand is about consistent delivery of high quality, desirable new homes supported by dedicated customer service, providing the perfect balance of product finish and service excellence.

Our dedicated customer service team spend up to 80% of their time on site, undertaking quality control checks throughout each and every apartment during construction to ensure consistently high standards of finish and function. Right up until completion, the team are spending time with buyers, carrying out pre-completion inspections. On the day of legal completion they complete handovers

and demonstrate all working features with our owners or their tenants.

Each customer service team member has a detailed knowledge of every Telford Homes development, so at any contact point they will be able to offer advice and answer most questions. For the first two years, we also provide a 24/7, 365 days a year free emergency service, to ensure there is always someone to help with any urgent problems that may arise out-of-hours.

Up to 65% of Telford Homes' customers buy with renting-out in mind at some stage.

Local contacts with reputable letting and management agencies, furnishing specialists and our own tenants induction service can all support you in this business. This (with proven yields and high occupancy levels over recent years) may well be why 99% of surveyed customers who took ownership of a Telford Homes property would recommend us to their friends and family.

This survey is provided by In-house Research, an independent market research company who interview our buyers six weeks after legal completion.

Award winning developers



Tel: +44 (0)1992 809800
 www.telfordhomes.london

Telford Homes Plc
 Telford House, Queensgate, Britannia Road, Waltham Cross, Herts EN8 7TF.

A joint venture between



These particulars are for illustration only. We operate a policy of continuous improvement and individual features such as kitchen and bathroom layouts, doors, windows and elevational treatments may vary from time to time. Specification details are for guide purposes only and remain subject to change without prior notice. Should a replacement be required this will be to an equal or higher standard. Consequently these particulars should be treated as general guidance only and cannot be relied upon as accurately describing any of the Specified Matters prescribed by any order made under the Property Misdescriptions Act 1991. Nor do they constitute a contract, part of a contract or a warranty. New Garden Quarter is a marketing name and may not form part of the final postal address. Computer generated images are indicative only and may be subject to change. Details correct at time of going to print E and OE.

A joint venture between Telford Homes Plc & Notting Hill Housing

www.telfordhomes.london